

2021 COUNTY SAFETY PROGRAM

4/25/2023 2:28 PM

COUNTY ROAD PROJECT NO: 2196

FEDERAL AID PROJECT NO. HSIP-000S(610)

F.A. CONTRACT # TA 7337

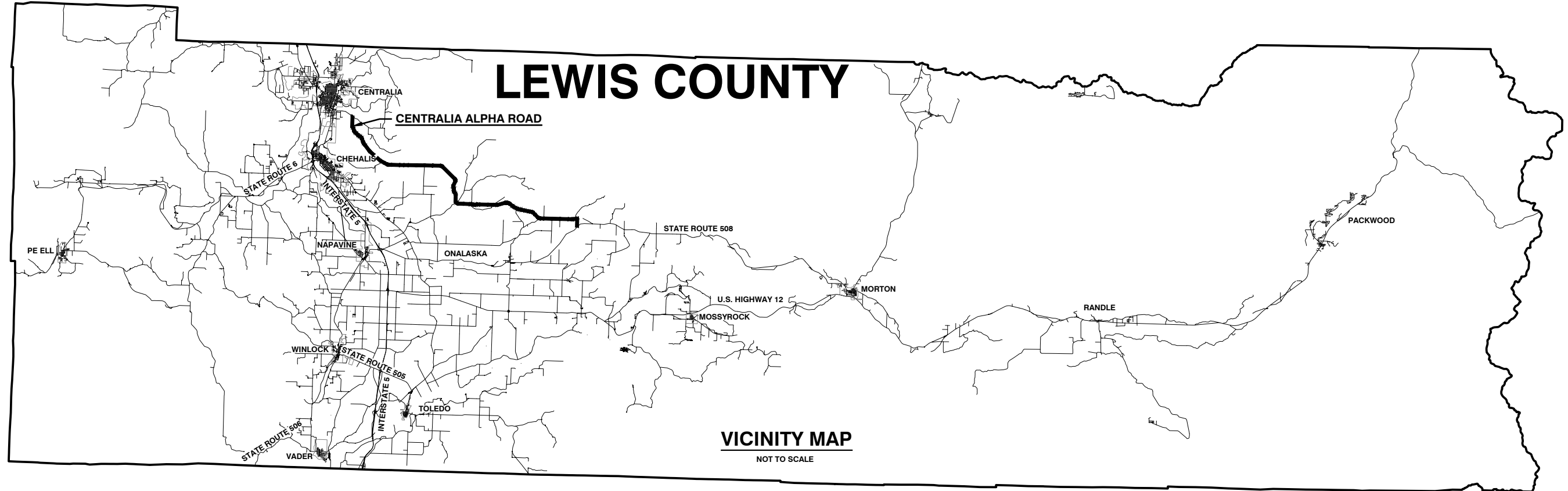

VICINITY MAP

NOT TO SCALE

ROADWAY SECTIONS INDEX	
SHEET NO.	DESCRIPTION
1	COVER SHEET
2	SUMMARY OF QUANTITIES & VICINITY MAP
3	LEGEND
4 - 5	TYPICAL SECTIONS
6 - 22	CENTRALIA ALPHA ROAD SITES
23	TRAFFIC CONTROL PLAN

COMMISSIONERS:

SEAN SWOPE, DISTRICT 1
 LINDSAY R. POLLOCK, DVM, DISTRICT 2
 SCOTT J. BRUMMER, DISTRICT 3



**ENGINEERING-
DESIGN SECTION**

LEWIS COUNTY
DEPARTMENT OF PUBLIC WORKS
APPROVED FOR CONSTRUCTION:

Assistant County Engineer

05/01/2023
Date



CENTRALIA ALPHA ROAD

SUMMARY OF QUANTITIES

ITEM NO.	STD. ITEM NO.	ITEM DESCRIPTION	TOTAL QUANTITY	UNIT
PREPARATION				
1	0001	MOBILIZATION	LUMP SUM	LUMP SUM
2	0170	REMOVING GUARDRAIL	125	L.F.
GRADING				
3	0310	ROADWAY EXCAVATION INCL. HAUL	9	C.Y.
DRAINAGE				
4	1180	SCHEDULE A CULV. PIPE 12 IN. DIAM.	495	L.F.
5	1270	CL. IV REINF. CONC. CULV. PIPE 12 IN. DIAM.	11.50	L.F.
SURFACING				
6	S.P.	CRUSHED SURFACING BASE COURSE	1,105	TON
EROSION CONTROL AND ROADSIDE PLANTING				
7	6419	SEEDING AND FERTILIZING BY HAND	44	S.Y.
8	6502	COIR LOG	1,605	L.F.
TRAFFIC				
9	6747	BEAM GUARDRAIL TYPE 1 - 9 FT. LONG POST	25	L.F.
10	6749	BEAM GUARDRAIL TYPE 1 - 11 FT. LONG POST	37.50	L.F.
11	6711	BEAM GUARDRAIL TYPE 31 - 8 FT. LONG POST	900	L.F.
12	6712	BEAM GUARDRAIL TYPE 31 - 9 FT. LONG POST	1,593.75	L.F.
13	6713	BEAM GUARDRAIL TYPE 31 - 11 FT. LONG POST	462.50	L.F.
14	6719	BEAM GUARDRAIL TYPE 31 NON - FLARED TERMINAL	10	EACH
15	6750	BEAM GUARDRAIL POST	50	EACH
16	6755	BEAM GUARDRAIL BLOCK	100	EACH
17	6757	BEAM GUARDRAIL TYPE 31	268.75	L.F.
18	6766	BEAM GUARDRAIL ANCHOR TYPE 10	8	EACH
19	S.P.	GUARDRAIL REFLECTOR	517	EACH
20	6783	RAISING EXISTING BEAM GUARDRAIL	8,487.50	L.F.
21	6971	PROJECT TEMPORARY TRAFFIC CONTROL	LUMP SUM	LUMP SUM
22	S.P.	WORK ZONE SAFETY CONTINGENCY	EST.	EST.
23	S.P.	UNDERGROUND UTILITY VERIFICATION POTHOLE	250	EACH
OTHER ITEMS				
24	7006	STRUCTURE EXCAVATION CLASS B INCL. HAUL	50	C.Y.
25	7490	TRIMMING AND CLEANUP	LUMP SUM	LUMP SUM
26	7562	MAILBOX SUPPORT TYPE 1	1	EACH
27	7725	REIMBURSEMENT FOR THIRD PARTY DAMAGE	EST.	EST.
28	7728	MINOR CHANGE	CALC	CALC
29	7736	SPCC PLAN	LUMP SUM	LUMP SUM
30	S.P.	CLEARING	LUMP SUM	LUMP SUM

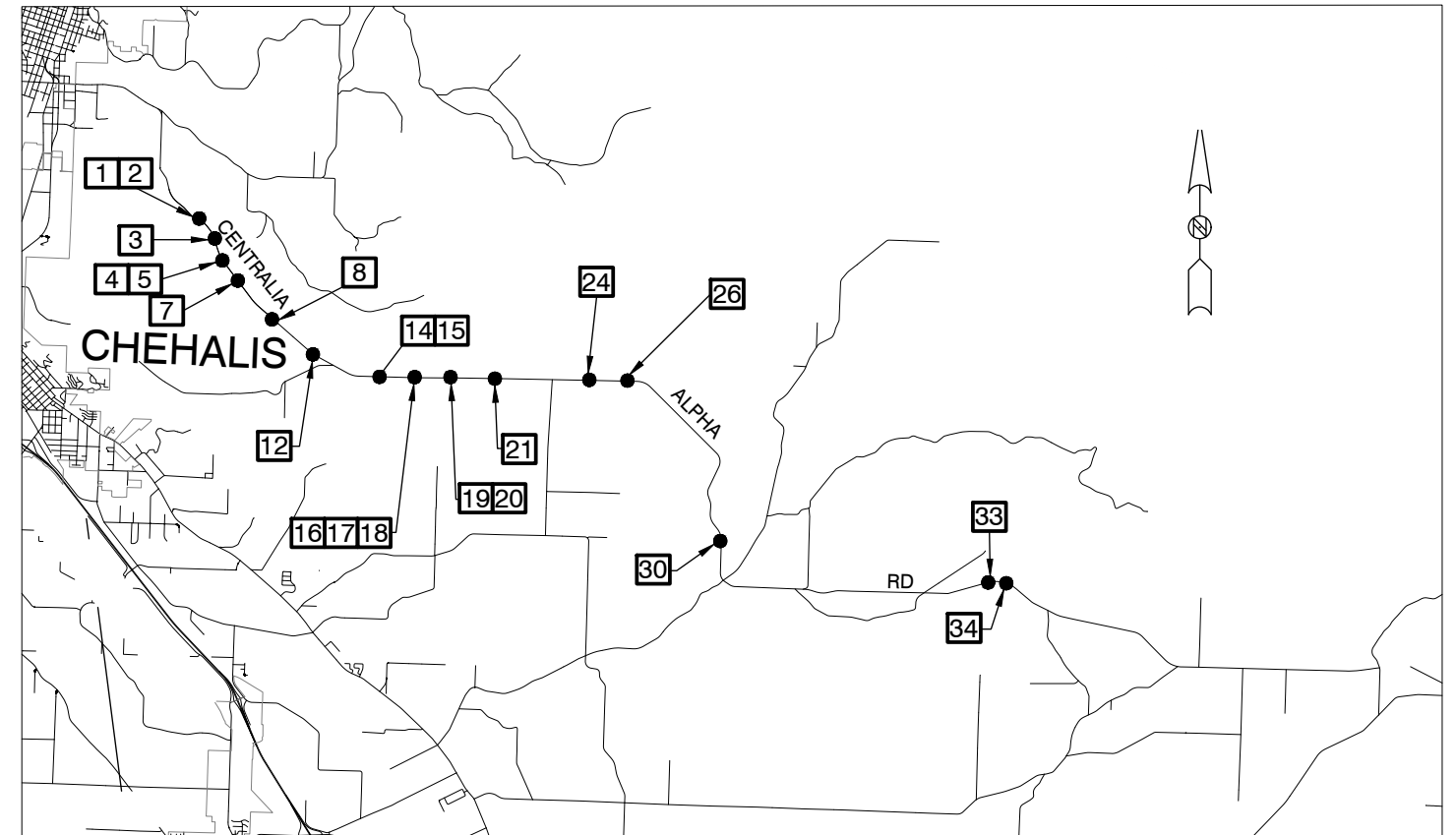

VICINITY MAP

NOT TO SCALE

4/25/2023 1:57 PM

S:\Engineer\Design\2022 HSIP\SUMMARY OF QUANTITIES.dwg

Lewis County
 Department of Public Works
 2025 NE KRESKY AVE.
 CHEHALIS WA 98532
 PHONE # (360) 740-1123
 FAX # (360) 740-2719

DESIGNED BY : WRA
 DRAWN BY : KLP
 CHECKED BY :
 DATE :

NO.	DATE	REVISION	BY	APP.

2021 COUNTY SAFETY PROGRAM

FEDERAL-AID NO: HSIP-000S(610)
 COUNTY ROAD PROJECT NO: 2196
 CENTRALIA ALPHA ROAD
 SUMMARY OF QUANTITIES

SHEET
2
 OF
23



Wesley R Anderson, P.E.
 Senior Engineer/Design
 Date: 04/28/2023



LEGEND

EXISTING FEATURES

	DITCH
	SHOULDER
	DRIVEWAY
	CENTERLINE
	ASPHALT
	FINAL - EXISTING RIGHT OF WAY
	GATE
	BUILDING
	GUARDRAIL
	UNDERGROUND TELEPHONE
	UNDERGROUND POWER
	POWER VAULT
	POWER POLE
	TRANSFORMER
	GUY WIRE
	CULVERT
	UTILITY OVERHEAD
	UTILITY TELEPHONE
	MAILBOX
	ROCK
	FENCE
	FENCE POST
	SIGN
	CONCRETE
	FRUIT TREE
	STUMP
	STREAM
	WETLAND

NEW CONSTRUCTION FEATURES

	CALLOUT
	CULVERT/ CULVERT EXTENSION
	LANDINGS & FILL SLOPES
	FILL
	CUT
	GUARDRAIL
	GUARDRAIL ANCHOR
	GUARDRAIL TERMINAL END
	COIR LOG

GENERAL NOTES

1. AT ALL TIMES FOR THE DURATION OF THE PROJECT, THE CONTRACTOR SHALL HAVE ON HAND, THE PROJECT CONTRACT PROVISIONS AND PLANS, AND A CURRENT EDITION OF THE WASHINGTON STATE DEPARTMENT OF TRANSPORTATION STANDARD SPECIFICATIONS FOR ROAD, BRIDGE, AND MUNICIPAL CONSTRUCTION (M 41-10).
2. THE CONTRACTOR SHALL COORDINATE, COOPERATE AND ASSIST IN THE INSPECTION PROCESSES THAT IS REQUIRED FOR THE COMPLETION OF THE PROJECT.
3. ALL NECESSARY CONSTRUCTION SURVEY REQUESTS SHALL BE GIVEN WITH A 3 DAY ADVANCE NOTICE. THE CONTRACTOR SHALL BE RESPONSIBLE FOR REPLACING NEEDED SURVEY STAKES DESTROYED THROUGH NORMAL OPERATIONS, NEGLIGENCE, OR INATTENTION.
4. AT THE END OF EACH DAY, THE CONTRACTOR SHALL CLEAN UP THE PROJECT AREA AND LEAVE IT IN A NEAT AND SECURED MANNER. UPON COMPLETION, THE CONTRACTOR SHALL LEAVE THE PROJECT FREE OF DEBRIS AND UNUSED MATERIAL.
5. THE CONTRACTOR IS TO MAINTAIN INGRESS AND EGRESS FROM THE PROJECT SITE, AND PRIVATE PROPERTY DRIVEWAYS DURING CONSTRUCTION.
6. AT A MINIMUM, THE CONTRACTOR IS TO MAINTAIN ALTERNATING ONE WAY TRAFFIC CONTROL UNLESS APPROVED TRAFFIC CONTROL PLAN ALLOWS OTHERWISE.

2025 NE KRESKY AVE.
CHEHALIS WA 98532
PHONE # (360) 740-1123
FAX # (360) 740-2719

DESIGNED BY : WRA
DRAWN BY : KLP
CHECKED BY :
DATE :

NO.	DATE	REVISION	BY	APP.

2021 COUNTY SAFETY PROGRAM

FEDERAL-AID NO: HSIP-000S(610)
COUNTY ROAD PROJECT NO: 2196
LEGEND

SHEET
3
OF
23

CALL 48 HOURS BEFORE YOU DIG
1-800-424-5555
"It's the Law"
Utilities Underground Location Center

Wesley R Anderson, P.E.
Senior Engineer/Design
Date: 04/28/2023

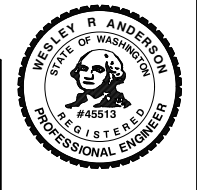

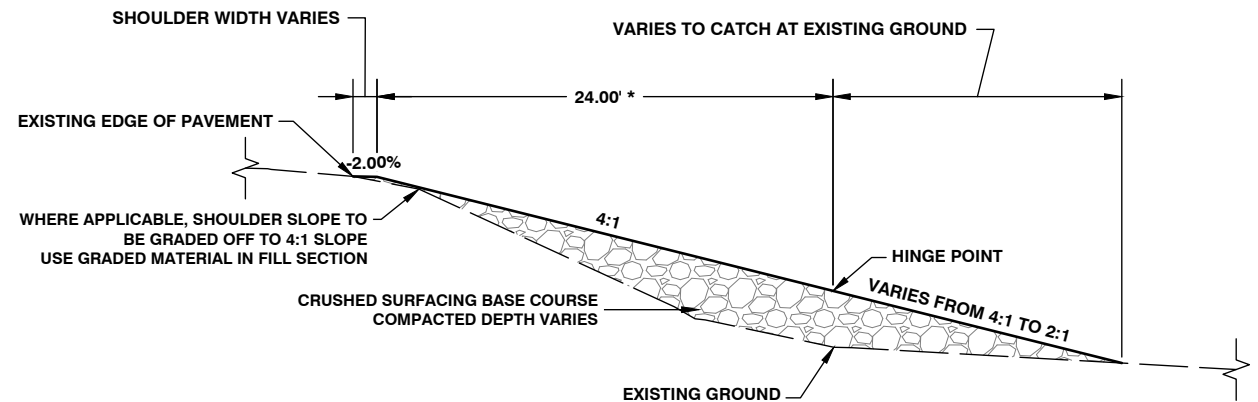

FILL SLOPE TYPICAL SECTION X
 (RIGHT SIDE DEPICTED) MIRROR FOR LEFT SIDE
 NOT TO SCALE

* SITE 3 DIMENSION SHALL BE 10.00'

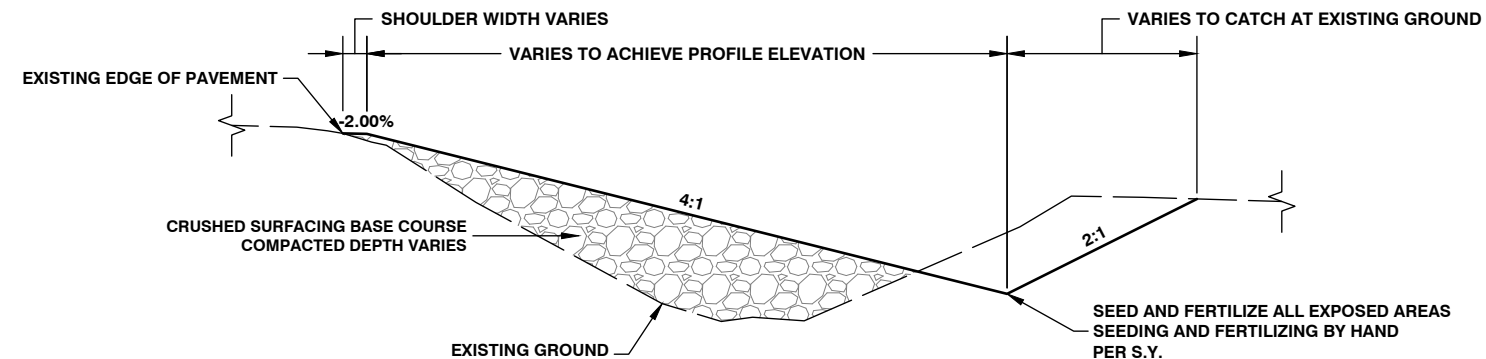

FILL SLOPE TYPICAL SECTION Y
 (RIGHT SIDE DEPICTED) MIRROR FOR LEFT SIDE
 NOT TO SCALE

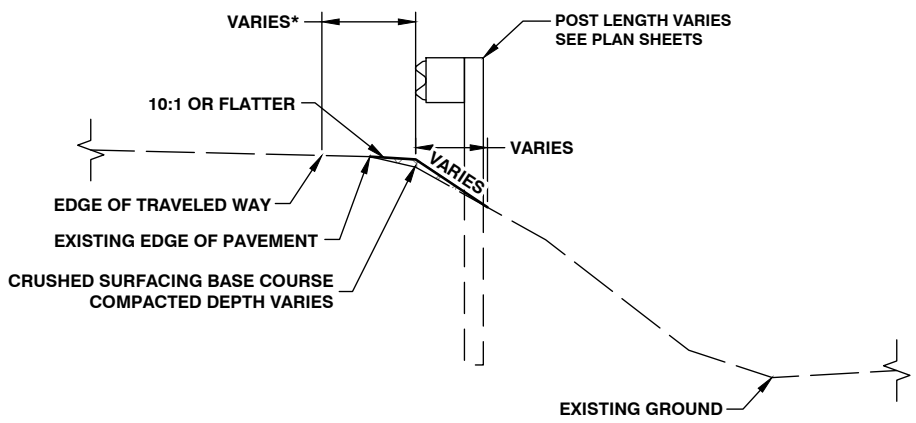

GUARDRAIL TYPICAL SECTION A**
 (RIGHT SIDE DEPICTED) MIRROR FOR LEFT SIDE
 NOT TO SCALE

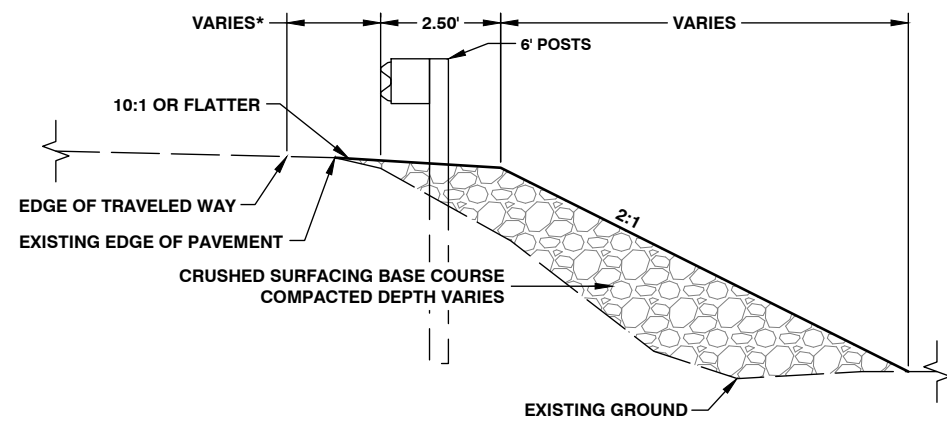

GUARDRAIL TYPICAL SECTION B**
 (RIGHT SIDE DEPICTED) MIRROR FOR LEFT SIDE
 NOT TO SCALE

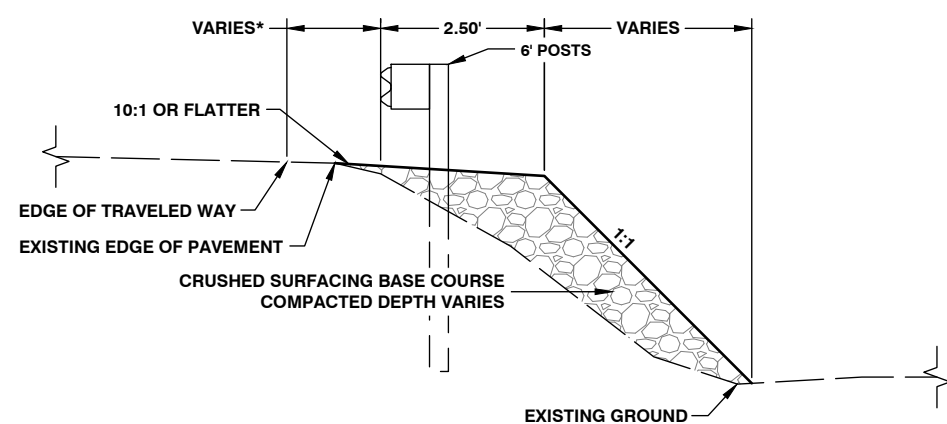

GUARDRAIL TYPICAL SECTION C**
 (RIGHT SIDE DEPICTED) MIRROR FOR LEFT SIDE
 NOT TO SCALE

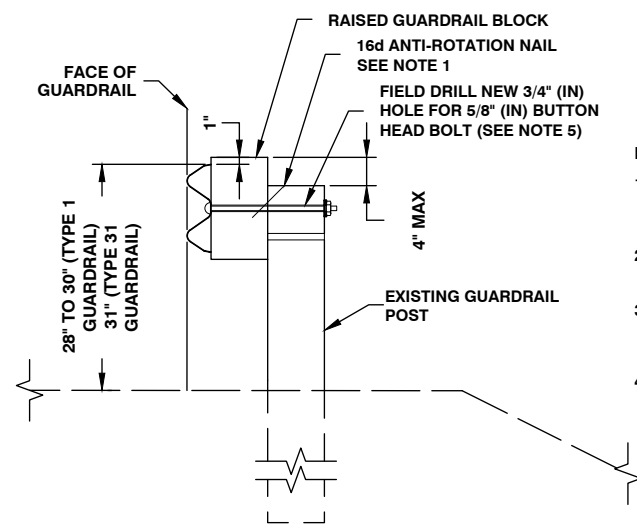

RAISING EXISTING BEAM GUARDRAIL DETAIL
 (RIGHT SIDE DEPICTED) MIRROR FOR LEFT SIDE
 NOT TO SCALE

- NOTES:
1. TIMBER BLOCKS SHALL BE TOE-NAILED TO THE POST WITH A 16D GALVANIZED NAIL TO PREVENT BLOCK ROTATION.
 2. FOR POST AND BLOCKS DETAILS, SEE STANDARD PLAN C-1B.
 3. EXISTING POSTS SHALL NOT BE RAISED. REPLACE POST AS NECESSARY TO ACHIEVE REQUIRED GUARDRAIL HEIGHT.
 4. FOR STEEL POSTS, HOLES SHALL BE LOCATED ON APPROACH TRAFFIC SIDE OF WEB.

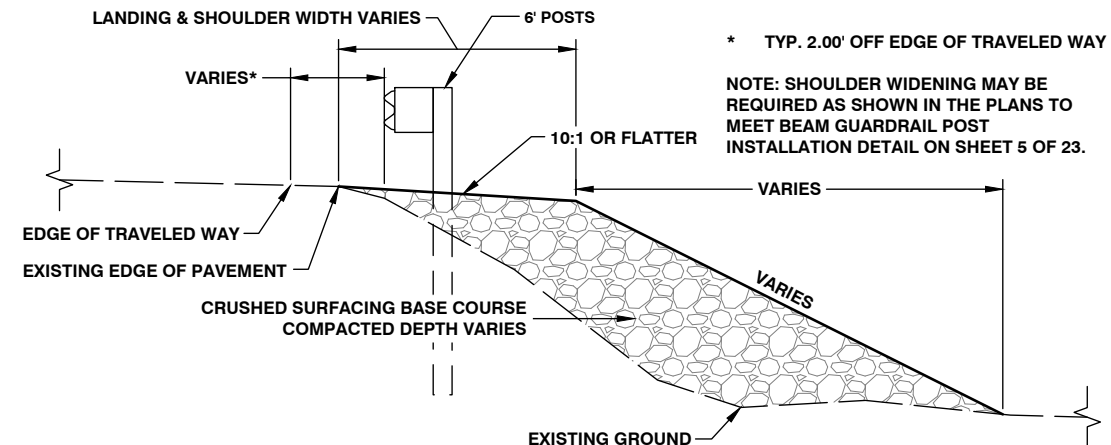

GUARDRAIL LANDING TYPICAL SECTION
 (RIGHT SIDE DEPICTED) MIRROR FOR LEFT SIDE
 NOT TO SCALE

* TYP. 2.00' OFF EDGE OF OF TRAVELED WAY

** NOTE: POST LENGTHS ARE LISTED FOR ESTIMATE PURPOSES ONLY. ACTUAL LENGTH OF POSTS WILL BE DICTATED BY ACTUAL FIELD CONDITIONS AND BEAM GUARDRAIL POST INSTALLATION DETAIL ON SHEET 5 OF 23. SHOULDER WIDENING MAY BE REQUIRED AS SHOWN IN THE PLANS TO MEET BEAM GUARDRAIL POST INSTALLATION DETAIL ON SHEET 5 OF 23.

* TYP. 2.00' OFF EDGE OF TRAVELED WAY

NOTE: SHOULDER WIDENING MAY BE REQUIRED AS SHOWN IN THE PLANS TO MEET BEAM GUARDRAIL POST INSTALLATION DETAIL ON SHEET 5 OF 23.

Lewis County
 Department of Public Works
 2025 N. E. KRESKY AVE.
 CHEHALIS WA 98532
 PHONE # (360) 740-1123
 FAX # (360) 740-2719

DESIGNED BY : WRA
 DRAWN BY : KLP
 CHECKED BY :
 DATE :

NO.	DATE	REVISION	BY	APP.

2021 COUNTY SAFETY PROGRAM

FEDERAL-AID NO: HSP1-000S(610)
 COUNTY ROAD PROJECT NO: 2196
 TYPICAL SECTIONS

SHEET
 4 OF 23



Wesley R Anderson, P.E.
 Senior Engineer/Design
 Date: 04/28/2023

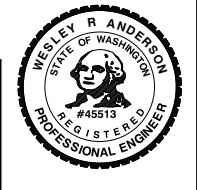

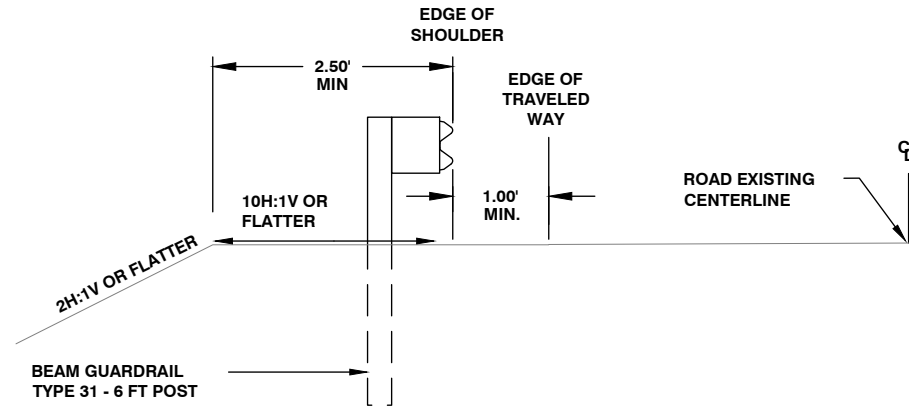

CASE 1
NOT TO SCALE

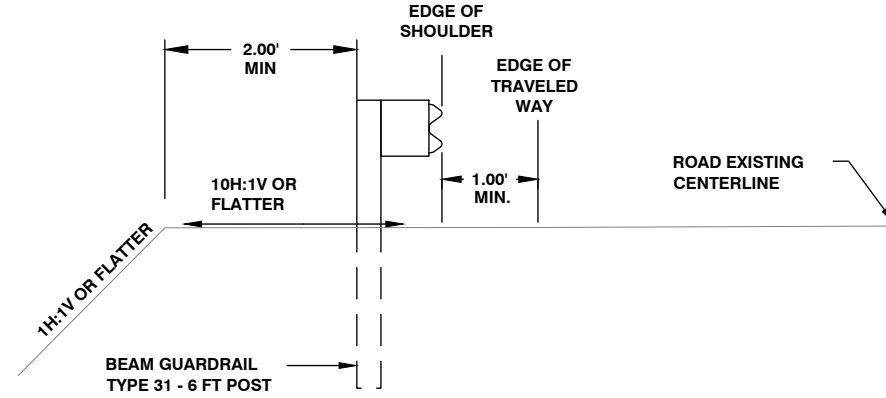

CASE 2
NOT TO SCALE

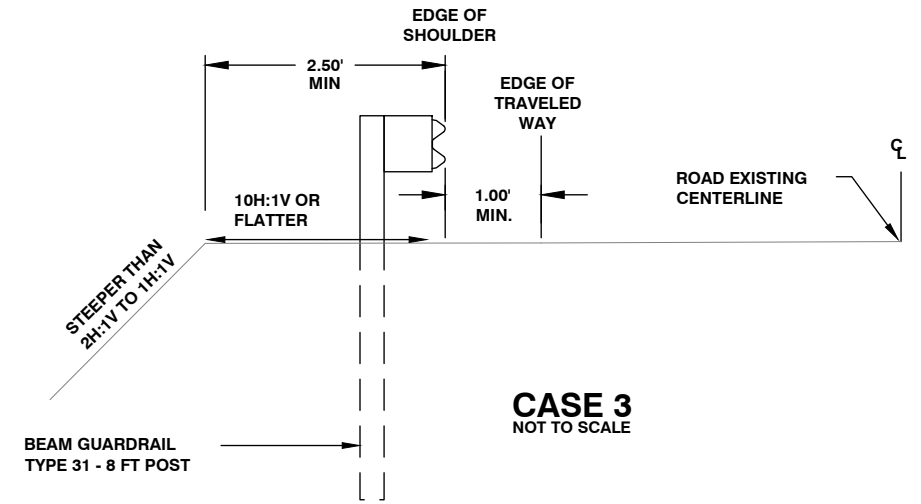

CASE 3
NOT TO SCALE

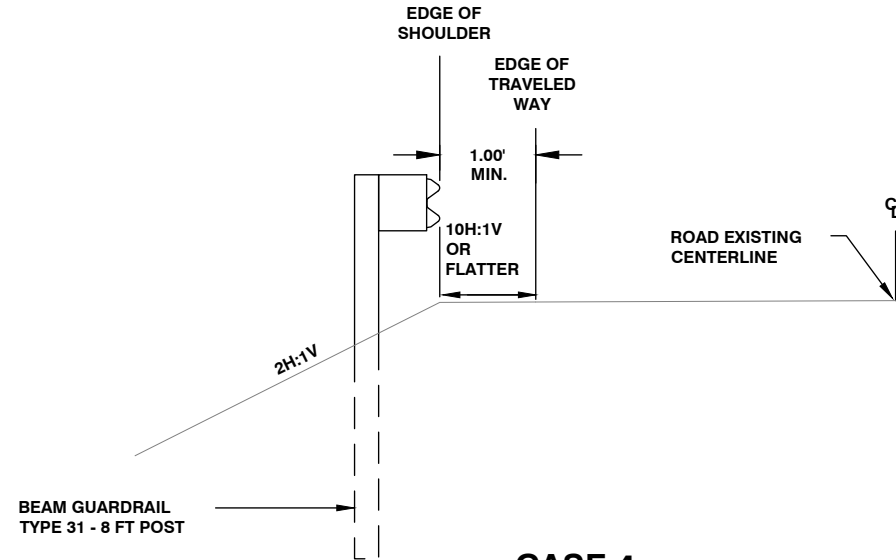

CASE 4
NOT TO SCALE

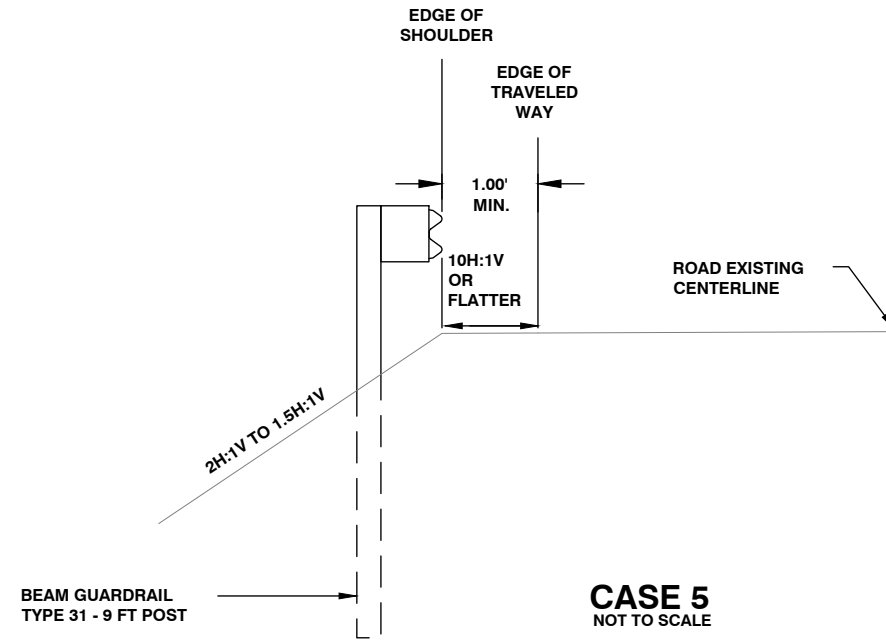

CASE 5
NOT TO SCALE

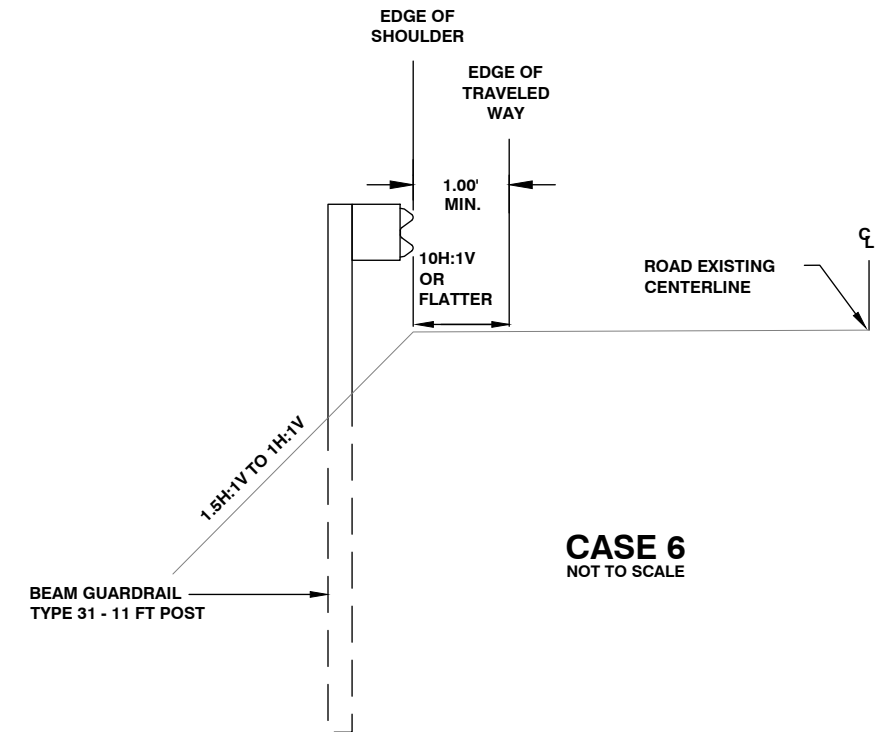

CASE 6
NOT TO SCALE

NO.	DATE	REVISION	BY	APP.



TOWNSHIP 14/15 NORTH, RANGE 2 WEST W.M.

- GENERAL NOTES**
- ① WHERE GUARDRAIL POSTS MAY CONFLICT WITH UTILITIES, UTILIZE UNDERGROUND UTILITY VERIFICATION POT HOLE PER THE ENGINEER.
 - ② INSTALL GUARDRAIL REFLECTOR ON GUARDRAIL EVERY 4TH POST EXCEPT ON GUARDRAIL RADIUS LESS THAN 50' SHALL BE EVERY POST. 10 EACH TOTAL THIS SITE

CONSTRUCTION NOTES: MP 1.35-1.42 RT

- ① 237.50 L.F. RAISING EXISTING BEAM GUARDRAIL
SEE RAISING EXISTING BEAM GUARDRAIL DETAIL ON SHEET 4 OF 23
12.50 L.F. REMOVING GUARDRAIL
12.50 L.F. BEAM GUARDRAIL TYPE 1 - 9 FT. LONG POST
USE STEEL POSTS

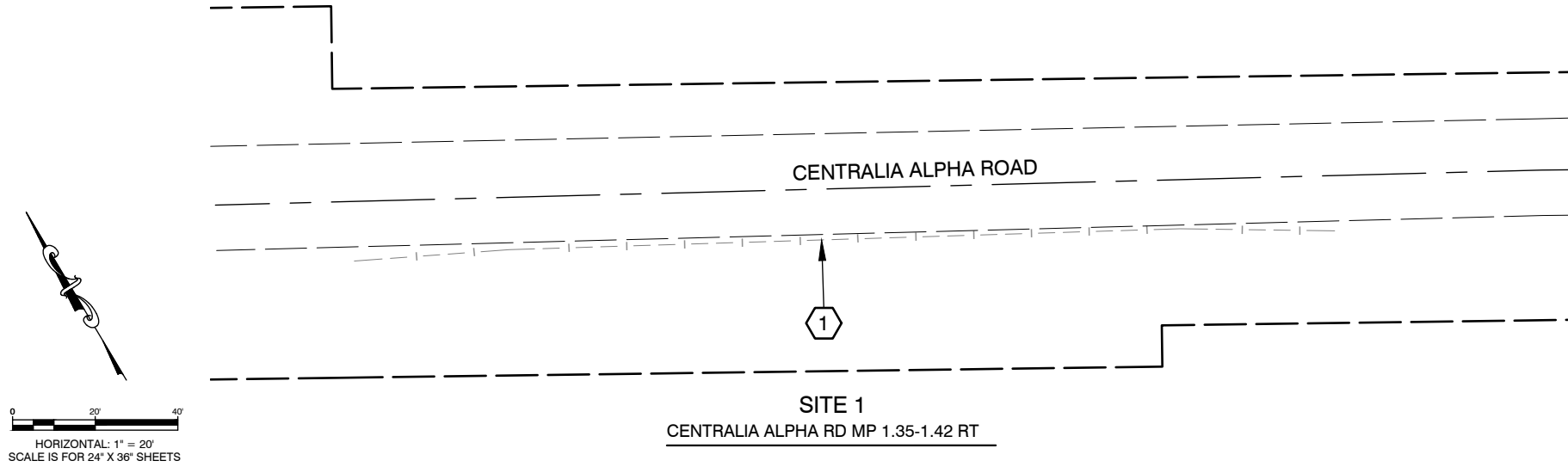

- GENERAL NOTES**
- ① WHERE GUARDRAIL POSTS MAY CONFLICT WITH UTILITIES, UTILIZE UNDERGROUND UTILITY VERIFICATION POT HOLE PER THE ENGINEER.
 - ② INSTALL GUARDRAIL REFLECTOR ON GUARDRAIL EVERY 4TH POST EXCEPT ON GUARDRAIL RADIUS LESS THAN 50' SHALL BE EVERY POST. 33 EACH TOTAL THIS SITE

CONSTRUCTION NOTES: MP 1.45-1.55 LT

- ② 362.50 L.F. RAISING EXISTING BEAM GUARDRAIL
SEE RAISING EXISTING BEAM GUARDRAIL DETAIL ON SHEET 4 OF 23

CONSTRUCTION NOTES: MP 1.45-1.56 RT

- ③ 437.50 L.F. RAISING EXISTING BEAM GUARDRAIL
SEE RAISING EXISTING BEAM GUARDRAIL DETAIL ON SHEET 4 OF 23
12.50 L.F. REMOVING GUARDRAIL
12.50 L.F. BEAM GUARDRAIL TYPE 1 - 9 FT. LONG POST

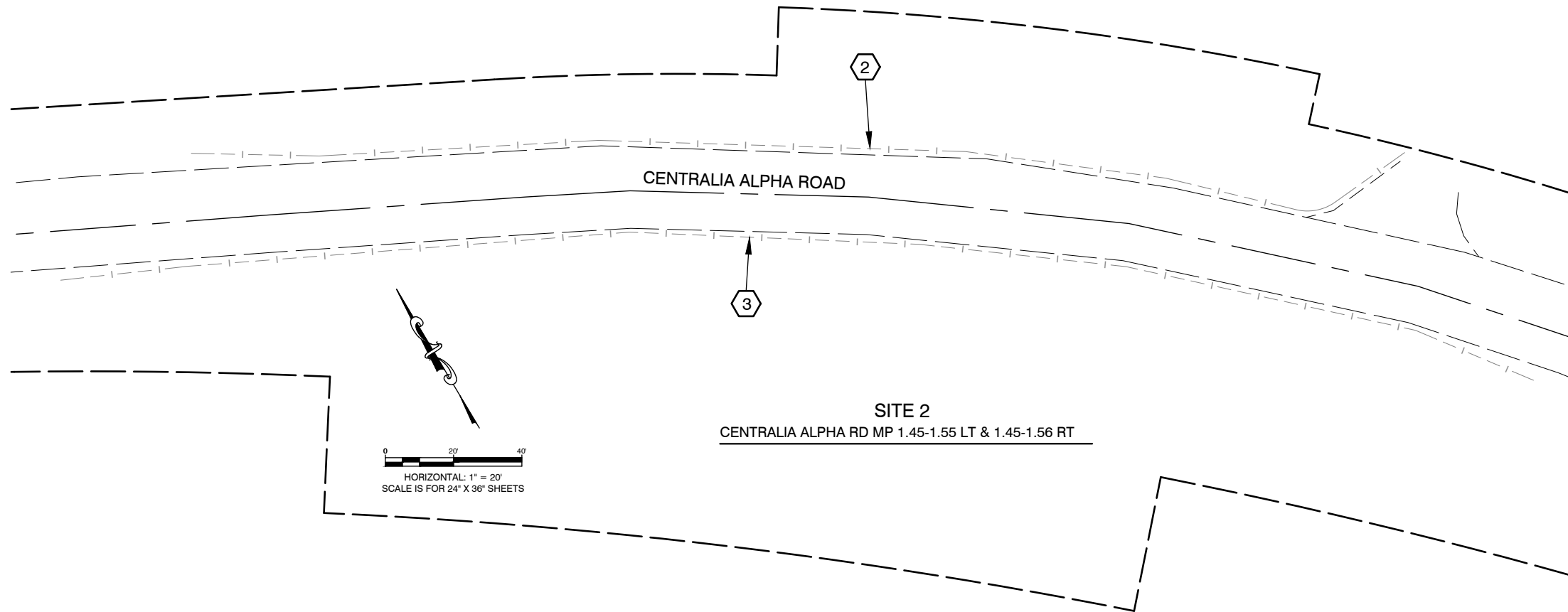

2025 NE KRESKY AVE.
CHEHALIS WA 98532
PHONE # (360) 740-1123
FAX # (360) 740-1479

DESIGNED BY :
DRAWN BY : KLP
CHECKED BY :
DATE :

NO.	DATE	REVISION	BY	APP.

2021 COUNTY SAFETY PROGRAM

FEDERAL-AID NO: HSIP-000S(610)
COUNTY ROAD PROJECT NO: 2196
CENTRALIA ALPHA ROAD SITE 1 & 2

SHEET
6
OF
23



Wesley R Anderson, P.E.
Senior Engineer/Design
Date: 04/28/2023

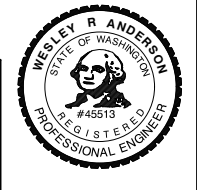

TOWNSHIP 14/15 NORTH, RANGE 2 WEST W.M.

- GENERAL NOTES**
- ① CLEARING SHALL BE PAID LUMP SUM PER SPECIAL PROVISIONS. ALL EMBANKMENT AREAS SHALL BE CLEARED PRIOR TO EMBANKMENT CONSTRUCTION AND AFTER INSTALLATION OF EROSION CONTROL BMPS.
 - ② INSTALL GUARDRAIL REFLECTOR ON GUARDRAIL EVERY 4TH POST EXCEPT ON GUARDRAIL RADIUS LESS THAN 50' SHALL BE EVERY POST. 19 EACH TOTAL THIS SITE
 - ③ SEE SHEET 4 OF 23 FOR TYPICAL SECTION VIEWS.
 - ④ WHERE GUARDRAIL POSTS MAY CONFLICT WITH UTILITIES, UTILIZE UNDERGROUND UTILITY VERIFICATION POT HOLE PER THE ENGINEER.

CONSTRUCTION NOTES: MP 1.75-1.85 LT

- ① 462.50 L.F. RAISING EXISTING BEAM GUARDRAIL
SEE RAISING EXISTING BEAM GUARDRAIL DETAIL ON SHEET 4 OF 23
12.50 L.F. REMOVING GUARDRAIL
12.50 L.F. BEAM GUARDRAIL TYPE 1 - 11 FT. LONG POST
2 EACH GUARDRAIL POST

CONSTRUCTION NOTES: MP 1.80-1.86 RT

- ② STA 101+40.89 RT TO STA 103+96.23 RT
CONSTRUCT EMBANKMENT
150 TON CRUSHED SURFACING BASE COURSE
- ③ STA 101+39.56 RT TO STA 103+96.23 RT
270 L.F. COIR LOG
SEE WSDOT STANDARD PLAN I-30.60

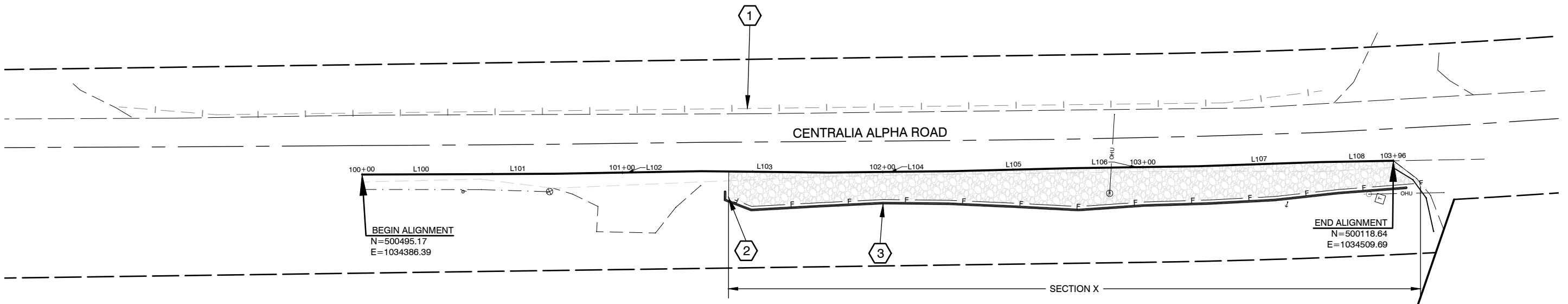

SITE 3
CENTRALIA ALPHA RD MP 1.75-1.85 LT & 1.80-1.86 RT

Line Table: Alignments

Line #	Length	Direction
L100	45.49	S17°33'13"E
L101	28.50	S17°39'36"E
L102	56.28	S18°22'24"E
L103	48.94	S16°46'44"E
L104	48.14	S17°59'18"E
L105	46.09	S18°48'30"E
L106	47.78	S18°14'17"E
L107	47.17	S19°18'54"E
L108	27.83	S18°24'18"E

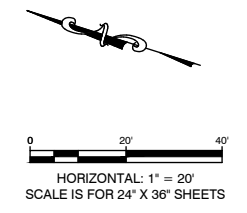

2025 NE KRESKY AVE.
CHEHALIS WA 98532
PHONE # (360) 740-1123
FAX # (360) 740-1479

DESIGNED BY : KLP
DRAWN BY : KLP
CHECKED BY : WRA
DATE :

NO.	DATE	REVISION	BY	APP.

2021 COUNTY SAFETY PROGRAM

FEDERAL-AID NO: HSP-000S(610)
COUNTY ROAD PROJECT NO: 2196
CENTRALIA ALPHA ROAD SITE 3

SHEET
7
OF
23



Wesley R Anderson, P.E.
Senior Engineer/Design
Date: 04/28/2023



TOWNSHIP 14/15 NORTH, RANGE 2 WEST W.M.

- GENERAL NOTES**
- CLEARING SHALL BE PAID LUMP SUM PER SPECIAL PROVISIONS. ALL EMBANKMENT AREAS SHALL BE CLEARED PRIOR TO EMBANKMENT CONSTRUCTION AND AFTER INSTALLATION OF EROSION CONTROL BMPs.
 - INSTALL GUARDRAIL REFLECTOR ON GUARDRAIL EVERY 4TH POST EXCEPT ON GUARDRAIL RADIUS LESS THAN 50' SHALL BE EVERY POST. 25 EACH TOTAL THIS SITE
 - WHERE GUARDRAIL POSTS MAY CONFLICT WITH UTILITIES, UTILIZE UNDERGROUND UTILITY VERIFICATION POTHOLE PER THE ENGINEER.

Line Table: Alignments

Line #	Length	Direction
L101	3.62	S38°51'47"E
L102	33.60	S36°51'36"E
L103	27.72	S36°27'20"E
L104	36.43	S37°07'39"E
L105	42.01	S36°50'14"E
L106	44.00	S37°05'40"E
L107	18.39	S37°09'06"E
L108	29.83	S36°32'45"E
L109	27.84	S37°12'27"E

Curve Table: Alignments

Curve #	Radius	Length	Chord Direction
C100	8.32	19.50	N76°01'25"E

CONSTRUCTION NOTES: MP 1.98-2.07 RT

- STA 100+00.00 RT TO STA 100+36.85 RT
CONSTRUCT EMBANKMENT
1 TON CRUSHED SURFACING BASE COURSE
SEE GUARDRAIL TYPICAL SECTION B ON SHEET 4 OF 23
- STA 100+00.50 RT TO STA 100+13.00 RT
1 EACH BEAM GUARDRAIL TYPE 31 ANCHOR 10
SEE STANDARD PLAN C-23.70
12.50 L.F. BEAM GUARDRAIL TYPE 31
SEE CASE 1 ON SHEET 5 OF 23
- STA 100+13.00 RT TO STA 101+19.25 RT
106.25 L.F. BEAM GUARDRAIL TYPE 31
SEE CASE 2 ON SHEET 5 OF 23
- STA 100+36.85, RT TO STA 101+50.00, RT
CONSTRUCT EMBANKMENT
15 TON CRUSHED SURFACING BASE COURSE
SEE GUARDRAIL TYPICAL SECTION C ON SHEET 4 OF 23
- STA 100+00.00 RT TO STA 101+26.00 RT
125 L.F. COIR LOG
SEE WSDOT STANDARD PLAN I-30.60
- STA 100+66.38 RT
OMIT POST
- STA 101+19.25, 0.23' RT TO STA 101+75.50, 0.34' RT
56.25 L.F. BEAM GUARDRAIL TYPE 31 - 8 FT LONG POSTS
SEE CASE 6 ON SHEET 5 OF 23
- STA 101+75.50, 0.34' RT TO STA 102+31.75, 0.48' RT
56.25 L.F. BEAM GUARDRAIL TYPE 31
SEE CASE 2 ON SHEET 5 OF 23
- STA 102+06.95 RT
62.50 L.F. REMOVE EXISTING GUARDRAIL
- STA 102+31.75, 0.48' RT
BEAM GUARDRAIL TYPE 31 TO BEAM GUARDRAIL TYPE 1 ADAPTOR
SEE STANDARD PLAN C-25.80
25 L.F. BEAM GUARDRAIL TYPE 31 - 8 FT LONG POSTS
SEE CASE 3 ON SHEET 5 OF 23
- STA 102+57.00 RT
225 L.F. RAISING EXISTING BEAM GUARDRAIL
SEE RAISING BEAM GUARDRAIL DETAIL ON SHEET 4 OF 23

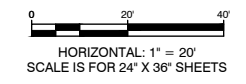
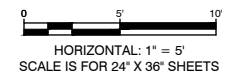
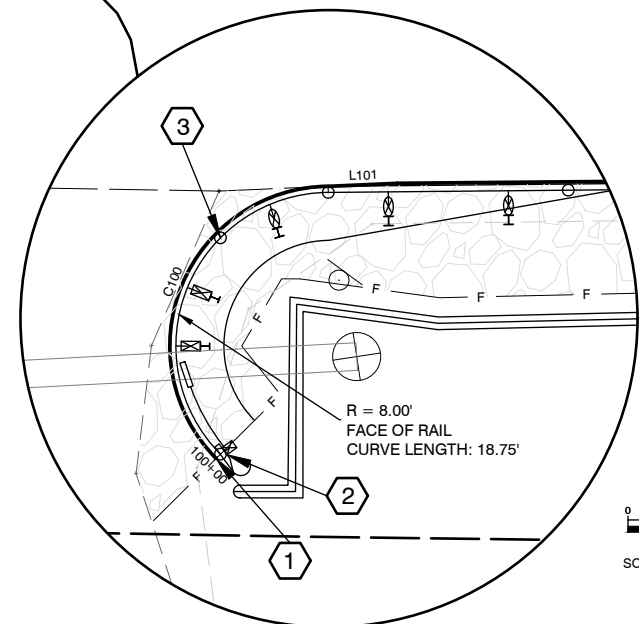
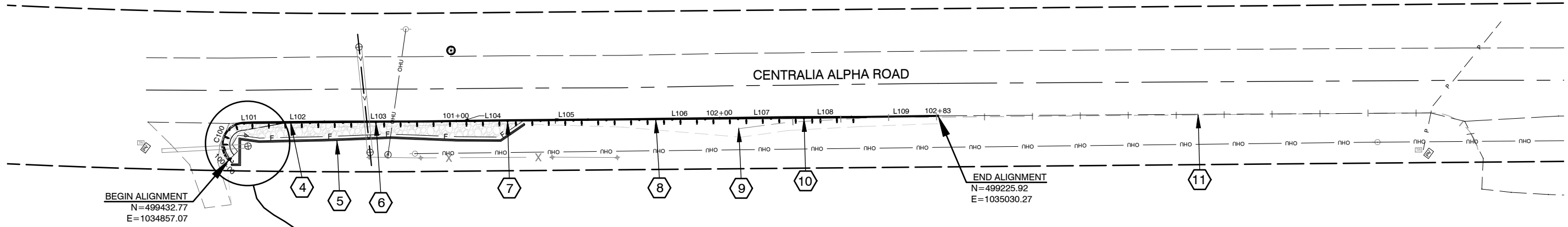

Lewis County
Department of Public Works

2025 NE KRESKY AVE.
CHEHALIS WA 98532
PHONE # (360) 740-1123
FAX # (360) 740-1479

DESIGNED BY : KLP
DRAWN BY : KLP
CHECKED BY : WRA
DATE :

NO.	DATE	REVISION	BY	APP.

2021 COUNTY SAFETY PROGRAM

FEDERAL-AID NO: HSIP-000S(610)
COUNTY ROAD PROJECT NO: 2196

CENTRALIA ALPHA ROAD SITE 4

SHEET
8
OF
23



Wesley R Anderson, P.E.
Senior Engineer/Design

Date: 04/28/2023



TOWNSHIP 14/15 NORTH, RANGE 2 WEST W.M.

- GENERAL NOTES**
- CLEARING SHALL BE PAID LUMP SUM PER SPECIAL PROVISIONS. ALL EMBANKMENT AREAS SHALL BE CLEARED PRIOR TO EMBANKMENT CONSTRUCTION AND AFTER INSTALLATION OF EROSION CONTROL BMPs.
 - INSTALL GUARDRAIL REFLECTOR ON GUARDRAIL EVERY 4TH POST EXCEPT ON GUARDRAIL RADIUS LESS THAN 50' SHALL BE EVERY POST. 29 EACH TOTAL THIS SITE
 - WHERE GUARDRAIL POSTS MAY CONFLICT WITH UTILITIES, UTILIZE UNDERGROUND UTILITY VERIFICATION POTHOLE PER THE ENGINEER.

CONSTRUCTION NOTES: 2.07-2.23 RT

- STA 100+00.00 RT TO STA 100+31.46, 0.00' RT
CONSTRUCT EMBANKMENT
5 TON CRUSHED SURFACING BASE COURSE
SEE GUARDRAIL TYPICAL SECTION B ON SHEET 4 OF 23
- STA 100+00.00, 0.00' RT TO STA 100+12.50, 0.00' RT
1 EACH BEAM GUARDRAIL TYPE 31 ANCHOR 10
SEE STANDARD PLAN C-23.70
12.50 L.F. BEAM GUARDRAIL TYPE 31
SEE CASE 1 ON SHEET 5 OF 23
- STA 100+12.50, 0.00' RT TO STA 101+43.77, 1.06' RT
131.25 L.F. BEAM GUARDRAIL TYPE 31 - 8 FT LONG POST
SEE CASE 4 ON SHEET 5 OF 23
- STA 101+25.00 RT TO STA 103+00.00, RT
CONSTRUCT EMBANKMENT
1 TON CRUSHED SURFACING BASE COURSE
SEE GUARDRAIL TYPICAL SECTION A ON SHEET 4 OF 23
- STA 101+43.77, 1.06' RT TO STA 103+50.03, 0.94' RT
206.25 L.F. BEAM GUARDRAIL TYPE 31 - 9 FT LONG POST
SEE CASE 5 ON SHEET 5 OF 23
- STA 103+50.03, 0.94' RT TO STA 105+50.03, 1.02' RT
200 L.F. BEAM GUARDRAIL TYPE 31 - 11 FT LONG POST
SEE CASE 6 ON SHEET 5 OF 23
- STA 105+50.03, 1.02' RT TO STA 106+18.77, 1.62' RT
68.75 L.F. BEAM GUARDRAIL TYPE 31 - 8 FT LONG POST
SEE CASE 4 ON SHEET 5 OF 23
- STA 105+98.10 RT TO STA 107+29.86 RT
CONSTRUCT EMBANKMENT
25 TON CRUSHED SURFACING BASE COURSE
SEE GUARDRAIL LANDING TYPICAL SECTION ON SHEET 4 OF 23
- STA 106+18.77, 1.62' RT TO STA 106+65.62, 2.82' RT
1 EACH BEAM GUARDRAIL TYPE 31 NON-FLARED TERMINAL
SEE STANDARD PLAN C22.40
- STA 106+09.70 RT
100 L.F. SCHEDULE A CULV. PIPE 12 IN. DIAM
10 C.Y. STRUCTURE EXCAVATION CLASS B INCL. HAUL
INLET INV. = EL 580.55 (STA 107+09.76, 5.63' RT)
OUTLET INV. = EL 577.25 (STA 106+09.70, 6.83' RT)

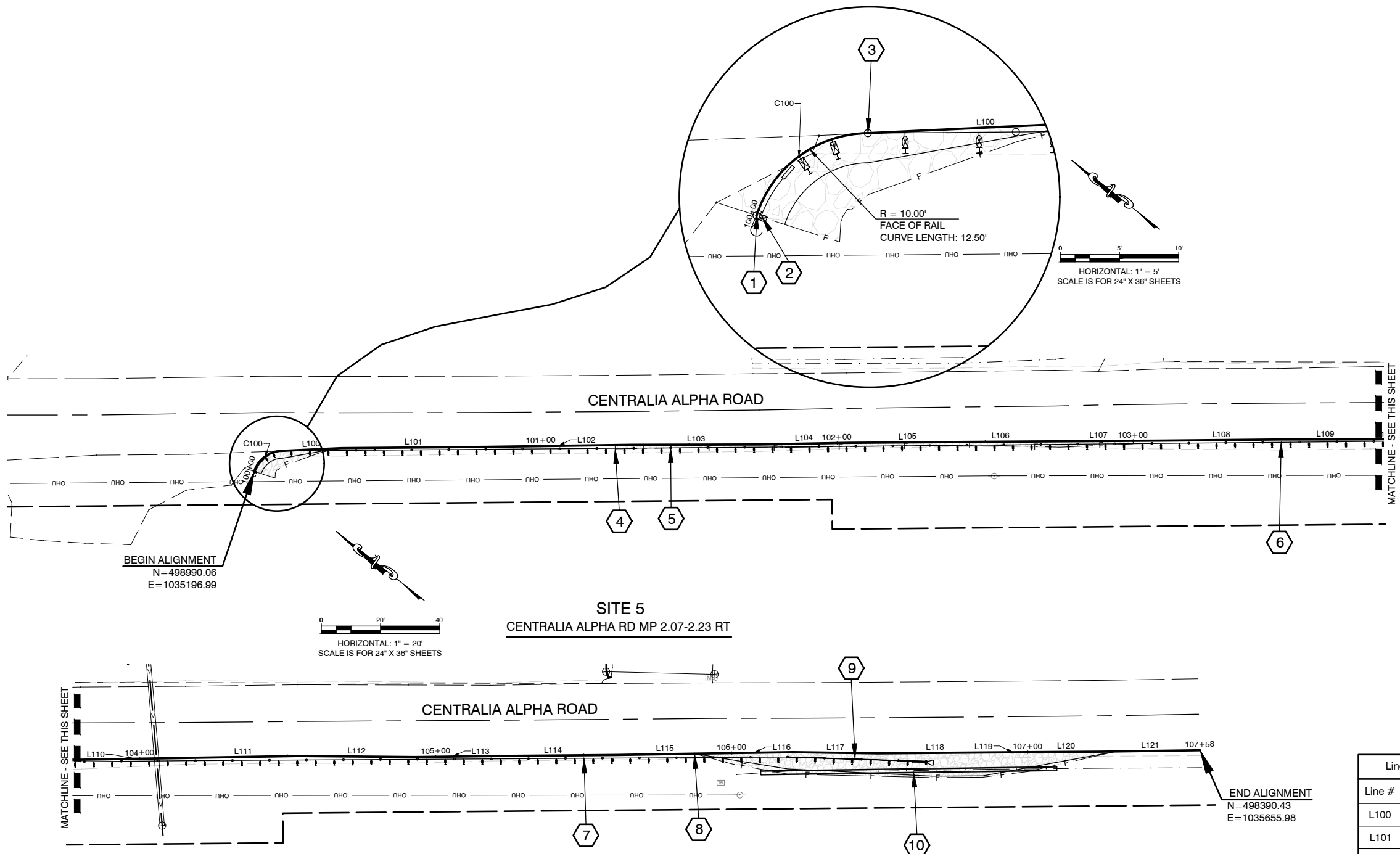

SITE 5
CENTRALIA ALPHA RD MP 2.07-2.23 RT

Line Table: Alignments

Line #	Length	Direction
L100	19.95	S39°03'49"E
L101	48.67	S36°51'47"E
L102	49.58	S37°10'39"E
L103	43.49	S36°31'09"E
L104	29.46	S37°26'43"E
L105	40.36	S36°47'34"E
L106	22.58	S36°43'56"E
L107	43.54	S36°46'40"E
L108	39.49	S36°54'16"E
L109	30.76	S36°24'24"E
L110	35.40	S37°21'17"E
L111	38.02	S37°19'40"E

Line Table: Alignments

Line #	Length	Direction
L112	38.92	S35°50'17"E
L113	25.93	S37°07'22"E
L114	41.94	S36°51'08"E
L115	33.85	S37°19'23"E
L116	26.21	S37°13'33"E
L117	28.83	S35°32'27"E
L118	38.48	S36°52'04"E
L119	13.81	S36°45'51"E
L120	22.45	S36°45'51"E
L121	33.95	S37°10'28"E

Curve Table: Alignments

Curve #	Radius	Length	Chord Direction
C100	10.00	12.50	S72°53'06"E

Lewis County
Department of Public Works

2025 NE KRESKY AVE.
CHEHALIS WA 98532
PHONE # (360) 740-1123
FAX # (360) 740-1479

NO.	DATE	REVISION	BY	APP.

DESIGNED BY : KLP
DRAWN BY : KLP
CHECKED BY : WRA
DATE :

2021 COUNTY SAFETY PROGRAM

FEDERAL-AID NO: HSP-000S(610)
COUNTY ROAD PROJECT NO: 2196

CENTRALIA ALPHA ROAD SITE 5

SHEET
9
OF
23



Wesley R Anderson, P.E.
Senior Engineer/Design

Date: 04/28/2023



TOWNSHIP 14/15 NORTH, RANGE 2 WEST W.M.

- GENERAL NOTES**
- ① WHERE GUARDRAIL POSTS MAY CONFLICT WITH UTILITIES, UTILIZE UNDERGROUND UTILITY VERIFICATION POTHOLE PER THE ENGINEER.
 - ② INSTALL GUARDRAIL REFLECTOR ON GUARDRAIL EVERY 4TH POST EXCEPT ON GUARDRAIL RADIUS LESS THAN 50' SHALL BE EVERY POST. 17 EACH TOTAL THIS SITE

CONSTRUCTION NOTES: MP 2.47-2.55 RT

- ① 412.50 L.F. RAISING EXISTING BEAM GUARDRAIL
SEE RAISING BEAM GUARDRAIL DETAIL ON SHEET 4 OF 23

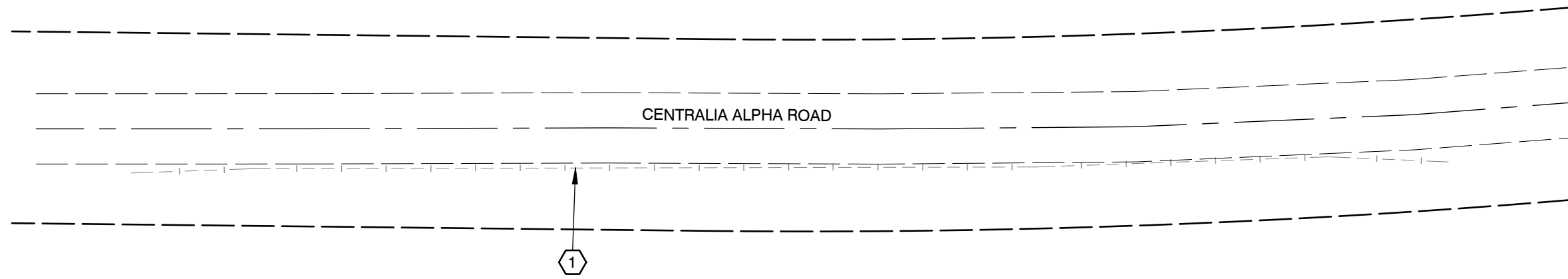

CENTRALIA ALPHA ROAD

1

SITE 7
CENTRALIA ALPHA RD MP 2.47-2.55 RT

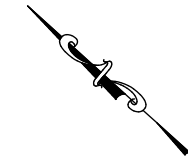

0 20' 40'
HORIZONTAL: 1" = 20'
SCALE IS FOR 24" X 36" SHEETS

2025 NE KRESKY AVE.
CHEHALIS WA 98532
PHONE # (360) 740-1123
FAX # (360) 740-1479

DESIGNED BY :
DRAWN BY : KLP
CHECKED BY :
DATE :

NO.	DATE	REVISION	BY	APP.

2021 COUNTY SAFETY PROGRAM

FEDERAL-AID NO: HSP-000S(610)
COUNTY ROAD PROJECT NO: 2196
CENTRALIA ALPHA ROAD SITE 7

SHEET
10
OF
23



Wesley R Anderson, P.E.
Senior Engineer/Design
Date: 04/28/2023



TOWNSHIP 14/15 NORTH, RANGE 2 WEST W.M.

- GENERAL NOTES**
- ① WHERE GUARDRAIL POSTS MAY CONFLICT WITH UTILITIES, UTILIZE UNDERGROUND UTILITY VERIFICATION POTHOLE PER THE ENGINEER.
 - ② INSTALL GUARDRAIL REFLECTOR ON GUARDRAIL EVERY 4TH POST EXCEPT ON GUARDRAIL RADIUS LESS THAN 50' SHALL BE EVERY POST. 12 EACH TOTAL THIS SITE

- CONSTRUCTION NOTES: MP 2.71-2.77 LT**
- ① 300 L.F. RAISING EXISTING BEAM GUARDRAIL
SEE RAISING BEAM GUARDRAIL DETAIL ON SHEET 4 OF 23

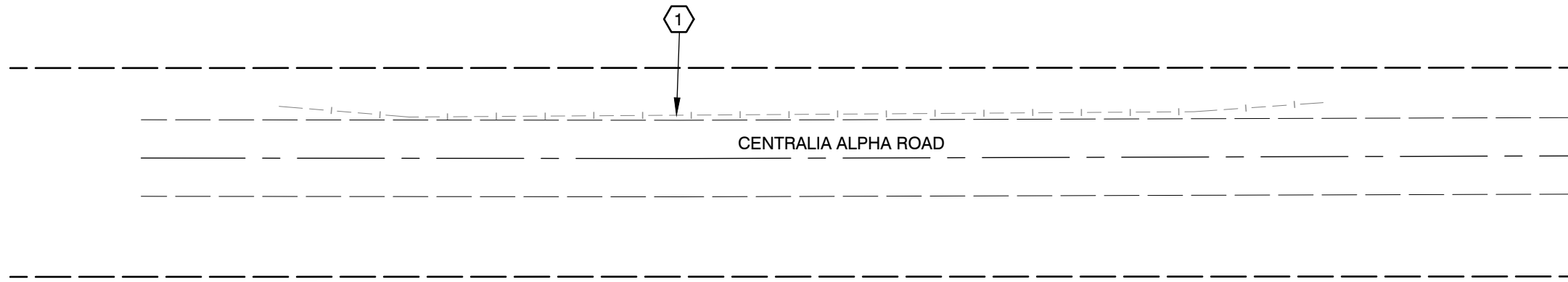

SITE 8
CENTRALIA ALPHA RD MP 2.71-2.77 LT

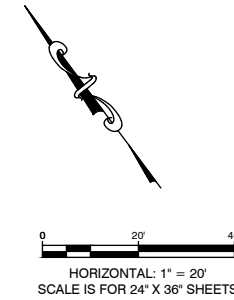

2025 NE KRESKY AVE.
CHEHALIS WA 98532
PHONE # (360) 740-1123
FAX # (360) 740-1479

DESIGNED BY : KLP
DRAWN BY : KLP
CHECKED BY : WRA
DATE :

NO.	DATE	REVISION	BY	APP.

2021 COUNTY SAFETY PROGRAM

FEDERAL-AID NO: HSIP-000S(610)
COUNTY ROAD PROJECT NO: 2196
CENTRALIA ALPHA ROAD SITE 8

SHEET
11
OF
23



Wesley R Anderson, P.E.
Senior Engineer/Design
Date: 04/28/2023



TOWNSHIP 14/15 NORTH, RANGE 2 WEST W.M.

- GENERAL NOTES**
- 1 WHERE GUARDRAIL POSTS MAY CONFLICT WITH UTILITIES, UTILIZE UNDERGROUND UTILITY VERIFICATION POTHOLE PER THE ENGINEER.
 - 2 INSTALL GUARDRAIL REFLECTOR ON GUARDRAIL EVERY 4TH POST EXCEPT ON GUARDRAIL RADIUS LESS THAN 50' SHALL BE EVERY POST. 42 EACH TOTAL THIS SITE

CONSTRUCTION NOTES: MP 3.49-3.64 LT

- 1 725.00 L.F. RAISING EXISTING BEAM GUARDRAIL
SEE RAISING BEAM GUARDRAIL DETAIL ON SHEET 4 OF 23

CONSTRUCTION NOTES: MP 3.45-3.53 RT

- 2 325.00 L.F. RAISING EXISTING BEAM GUARDRAIL
SEE RAISING BEAM GUARDRAIL DETAIL ON SHEET 4 OF 23

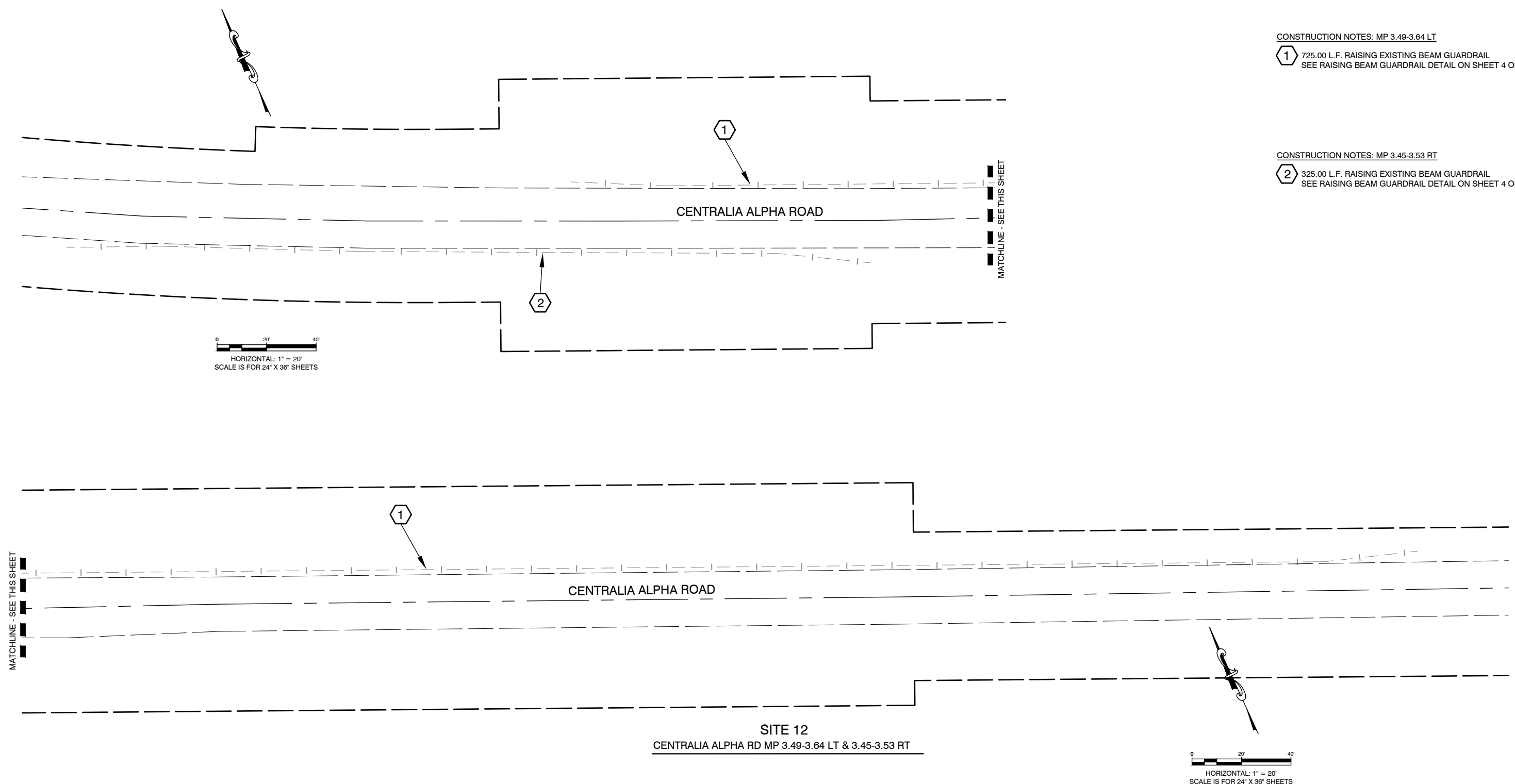

Lewis County
 Department of Public Works
 2025 NE KRESKY AVE.
 CHEHALIS WA 98532
 PHONE # (360) 740-1123
 FAX # (360) 740-1479

DESIGNED BY :
 DRAWN BY : KLP
 CHECKED BY :
 DATE :

NO.	DATE	REVISION	BY	APP.

2021 COUNTY SAFETY PROGRAM

FEDERAL-AID NO: HSIP-000S(610)
 COUNTY ROAD PROJECT NO: 2196
 CENTRALIA ALPHA ROAD SITE 12

SHEET
12
 OF
23



Wesley R Anderson, P.E.
 Senior Engineer/Design
 Date: 04/28/2023



TOWNSHIP 14/15 NORTH, RANGE 2 WEST W.M.

- GENERAL NOTES**
- ① WHERE GUARDRAIL POSTS MAY CONFLICT WITH UTILITIES, UTILIZE UNDERGROUND UTILITY VERIFICATION POTHOLE PER THE ENGINEER.
 - ② INSTALL GUARDRAIL REFLECTOR ON GUARDRAIL EVERY 4TH POST EXCEPT ON GUARDRAIL RADIUS LESS THAN 50' SHALL BE EVERY POST. 9 EACH TOTAL THIS SITE

CONSTRUCTION NOTES: MP 4.08-4.14 LT

- ① 212.50 L.F. RAISING EXISTING BEAM GUARDRAIL
SEE RAISING BEAM GUARDRAIL DETAIL ON SHEET 4 OF 23

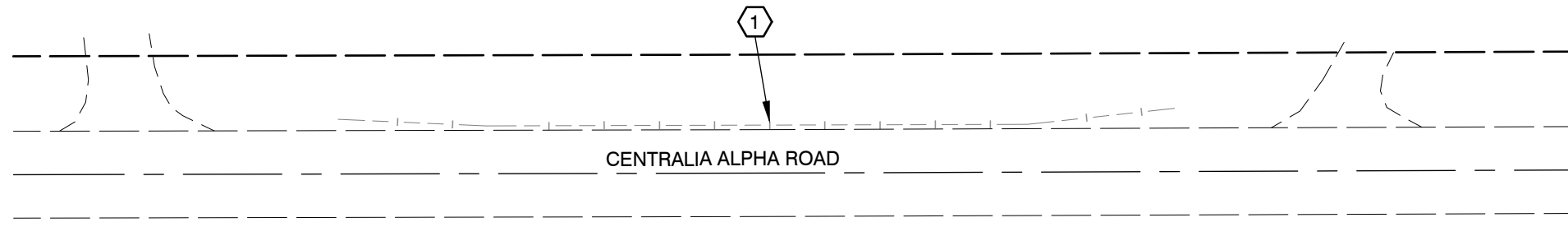

CENTRALIA ALPHA ROAD

SITE 14
CENTRALIA ALPHA RD MP 4.08-4.14 LT

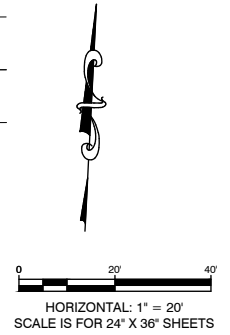

- GENERAL NOTES**
- ① WHERE GUARDRAIL POSTS MAY CONFLICT WITH UTILITIES, UTILIZE UNDERGROUND UTILITY VERIFICATION POTHOLE PER THE ENGINEER.
 - ② INSTALL GUARDRAIL REFLECTOR ON GUARDRAIL EVERY 4TH POST EXCEPT ON GUARDRAIL RADIUS LESS THAN 50' SHALL BE EVERY POST. 15 EACH TOTAL THIS SITE

CONSTRUCTION NOTES: MP 4.17-4.26 LT

- ① 375.00 L.F. RAISING EXISTING BEAM GUARDRAIL
SEE RAISING BEAM GUARDRAIL DETAIL ON SHEET 4 OF 23

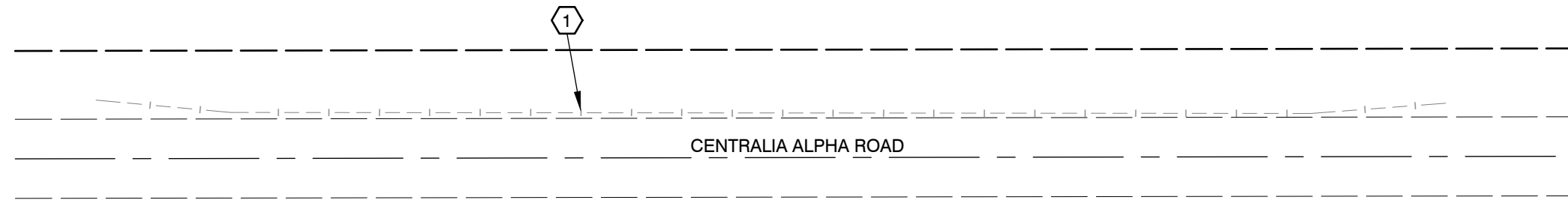

CENTRALIA ALPHA ROAD

SITE 15
CENTRALIA ALPHA RD MP 4.17-4.26 LT

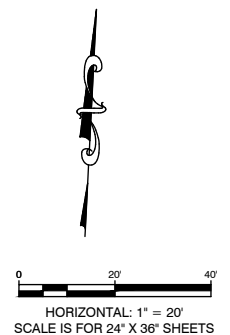

2025 NE KRESKY AVE.
CHEHALIS WA 98532
PHONE # (360) 740-1123
FAX # (360) 740-1479

DESIGNED BY :
DRAWN BY : KLP
CHECKED BY :
DATE :

NO.	DATE	REVISION	BY	APP.

2021 COUNTY SAFETY PROGRAM

FEDERAL-AID NO: HSP-000S(610)
COUNTY ROAD PROJECT NO: 2196
CENTRALIA ALPHA ROAD SITE 14 & 15

SHEET
13
OF
23



Wesley R Anderson, P.E.
Senior Engineer/Design
Date: 04/28/2023

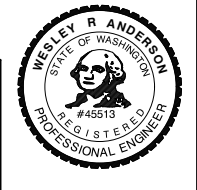

TOWNSHIP 14/15 NORTH, RANGE 2 WEST W.M.

- GENERAL NOTES**
- ① WHERE GUARDRAIL POSTS MAY CONFLICT WITH UTILITIES, UTILIZE UNDERGROUND UTILITY VERIFICATION POTHOLE PER THE ENGINEER.
 - ② INSTALL GUARDRAIL REFLECTOR ON GUARDRAIL EVERY 4TH POST EXCEPT ON GUARDRAIL RADIUS LESS THAN 50' SHALL BE EVERY POST. 28 EACH TOTAL THIS SITE

CONSTRUCTION NOTES: MP 4.43-4.52 LT

- ① 400 L.F. RAISING EXISTING BEAM GUARDRAIL
SEE RAISING BEAM GUARDRAIL DETAIL ON SHEET 4 OF 23

CONSTRUCTION NOTES: MP 4.44-4.51 RT

- ② 300 L.F. RAISING EXISTING BEAM GUARDRAIL
SEE RAISING BEAM GUARDRAIL DETAIL ON SHEET 4 OF 23
- 12.50 L.F. REMOVING GUARDRAIL
- 12.50 L.F. BEAM GUARDRAIL TYPE 1 - 11 FT. LONG POST

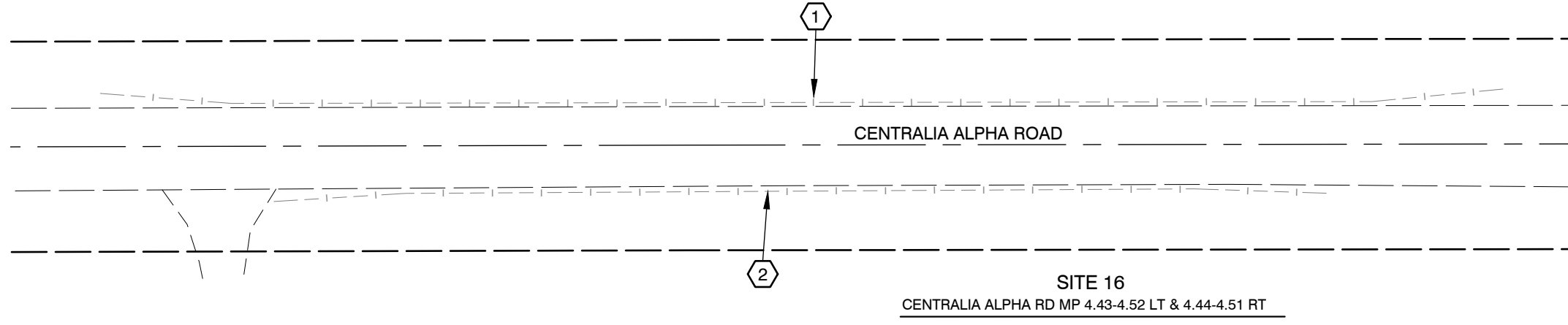

SITE 16
CENTRALIA ALPHA RD MP 4.43-4.52 LT & 4.44-4.51 RT

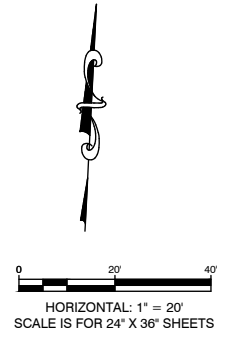

- GENERAL NOTES**
- ① WHERE GUARDRAIL POSTS MAY CONFLICT WITH UTILITIES, UTILIZE UNDERGROUND UTILITY VERIFICATION POTHOLE PER THE ENGINEER.
 - ② INSTALL GUARDRAIL REFLECTOR ON GUARDRAIL EVERY 4TH POST EXCEPT ON GUARDRAIL RADIUS LESS THAN 50' SHALL BE EVERY POST. 16 EACH TOTAL THIS SITE

CONSTRUCTION NOTES: MP 4.75-4.80 LT

- ① 187.50 L.F. RAISING EXISTING BEAM GUARDRAIL
SEE RAISING BEAM GUARDRAIL DETAIL ON SHEET 4 OF 23

CONSTRUCTION NOTES: MP 4.75-4.80 RT

- ② 187.50 L.F. RAISING EXISTING BEAM GUARDRAIL
SEE RAISING BEAM GUARDRAIL DETAIL ON SHEET 4 OF 23

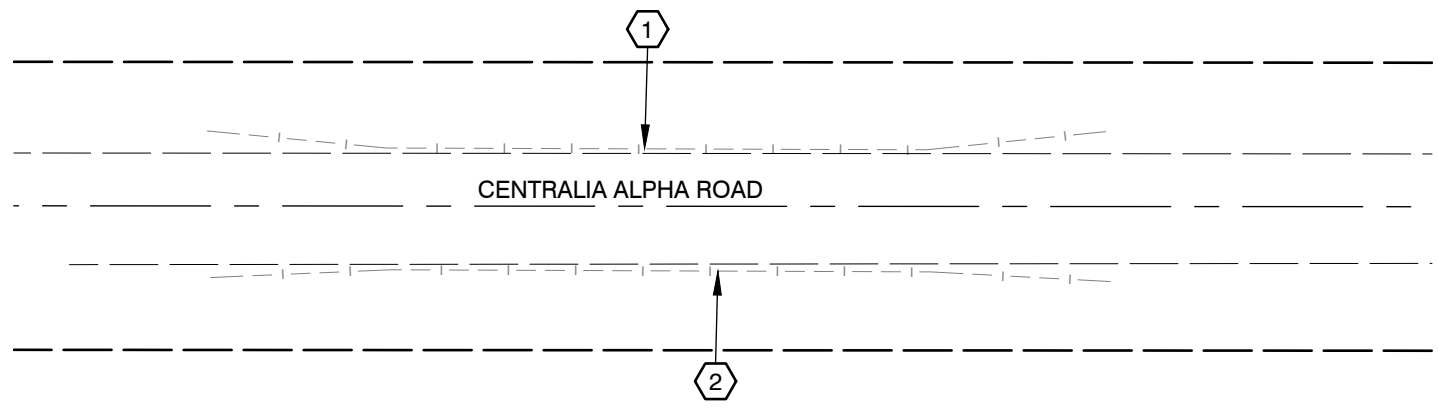

SITE 17
CENTRALIA ALPHA RD MP 4.75-4.80 LT & 4.75-4.80 RT

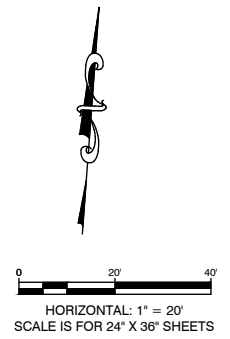

Lewis County
Department of Public Works

2025 NE KRESKY AVE.
CHEHALIS WA 98532
PHONE # (360) 740-1123
FAX # (360) 740-1479

DESIGNED BY :	NO.	DATE	REVISION	BY	APP.
DRAWN BY : KLP					
CHECKED BY :					
DATE :					

2021 COUNTY SAFETY PROGRAM

FEDERAL-AID NO: HSP-000S(610)
COUNTY ROAD PROJECT NO: 2196
CENTRALIA ALPHA ROAD SITE 16 & 17

SHEET
14
OF
23



Wesley R Anderson, P.E.
Senior Engineer/Design
Date: 04/28/2023

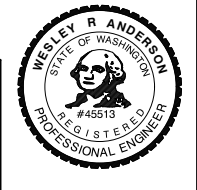

TOWNSHIP 14/15 NORTH, RANGE 1 WEST W.M.

- GENERAL NOTES**
- ① WHERE GUARDRAIL POSTS MAY CONFLICT WITH UTILITIES, UTILIZE UNDERGROUND UTILITY VERIFICATION POTHOLE PER THE ENGINEER.
 - ② INSTALL GUARDRAIL REFLECTOR ON GUARDRAIL EVERY 4TH POST EXCEPT ON GUARDRAIL RADIUS LESS THAN 50' SHALL BE EVERY POST. 19 EACH TOTAL THIS SITE

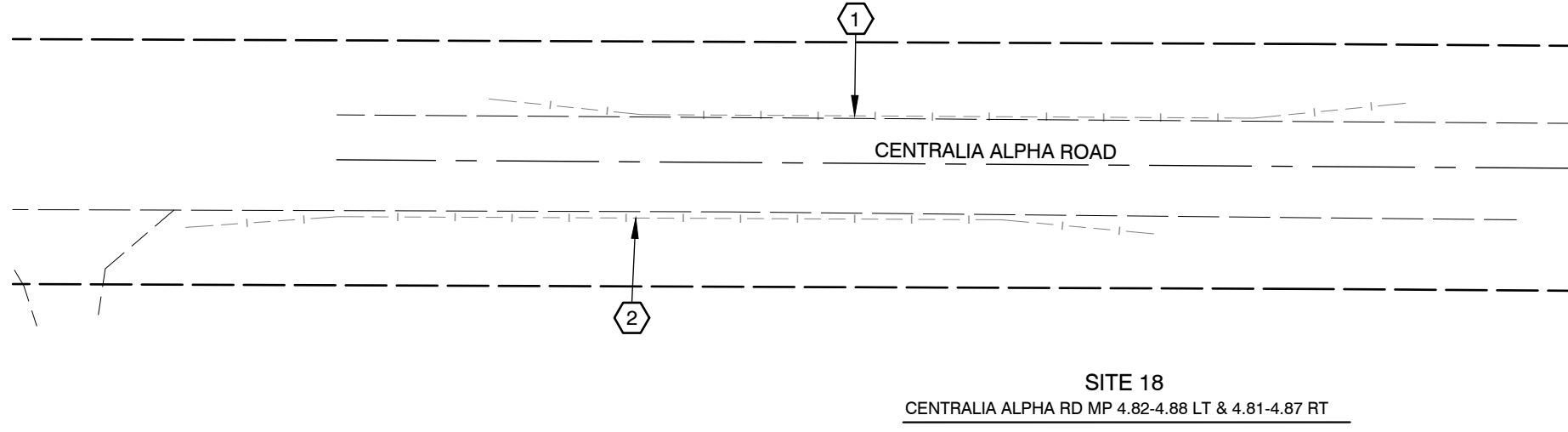

SITE 18
CENTRALIA ALPHA RD MP 4.82-4.88 LT & 4.81-4.87 RT

CONSTRUCTION NOTES: MP 4.82-4.88 LT

- ① 225.00 L.F. RAISING EXISTING BEAM GUARDRAIL
SEE RAISING BEAM GUARDRAIL DETAIL ON SHEET 4 OF 23

CONSTRUCTION NOTES: MP 4.81-4.87 RT

- ② 237.50 L.F. RAISING EXISTING BEAM GUARDRAIL
SEE RAISING BEAM GUARDRAIL DETAIL ON SHEET 4 OF 23

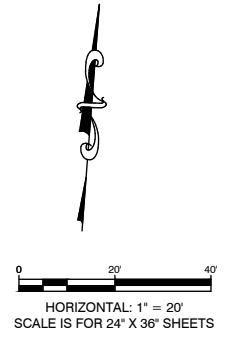

CONSTRUCTION NOTES: MP 5.02-5.11 LT

- ① 387.50 L.F. RAISING EXISTING BEAM GUARDRAIL
SEE RAISING BEAM GUARDRAIL DETAIL ON SHEET 4 OF 23

CONSTRUCTION NOTES: MP 5.03-5.11 RT

- ② 400 L.F. RAISING EXISTING BEAM GUARDRAIL
SEE RAISING BEAM GUARDRAIL DETAIL ON SHEET 4 OF 23
- 12.50 L.F. REMOVING GUARDRAIL
- 12.50 L.F. BEAM GUARDRAIL TYPE 1 - 11 FT. LONG POST
- 1 EACH BEAM GUARDRAIL ANCHOR TYPE 10

- GENERAL NOTES**
- ① WHERE GUARDRAIL POSTS MAY CONFLICT WITH UTILITIES, UTILIZE UNDERGROUND UTILITY VERIFICATION POTHOLE PER THE ENGINEER.
 - ② INSTALL GUARDRAIL REFLECTOR ON GUARDRAIL EVERY 4TH POST EXCEPT ON GUARDRAIL RADIUS LESS THAN 50' SHALL BE EVERY POST. 32 EACH TOTAL THIS SITE

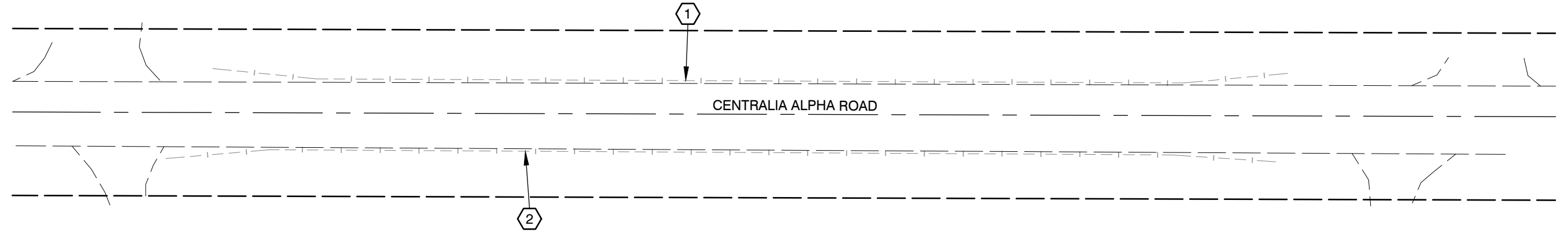

SITE 19
CENTRALIA ALPHA RD MP 5.02-5.11 LT & 5.03-5.11 RT

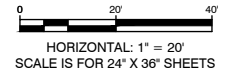

2025 NE KRESKY AVE.
CHEHALIS WA 98532
PHONE # (360) 740-1123
FAX # (360) 740-1479

DESIGNED BY :	NO.	DATE	REVISION	BY	APP.
DRAWN BY : KLP					
CHECKED BY :					
DATE :					

2021 COUNTY SAFETY PROGRAM

FEDERAL-AID NO: HSIP-000S(610)
COUNTY ROAD PROJECT NO: 2196
CENTRALIA ALPHA ROAD SITE 18 & 19

SHEET
15
OF
23



Wesley R Anderson, P.E.
Senior Engineer/Design
Date: 04/28/2023



TOWNSHIP 14/15 NORTH, RANGE 1 WEST W.M.

- GENERAL NOTES**
- ① WHERE GUARDRAIL POSTS MAY CONFLICT WITH UTILITIES, UTILIZE UNDERGROUND UTILITY VERIFICATION POTHOLE PER THE ENGINEER.
 - ② INSTALL GUARDRAIL REFLECTOR ON GUARDRAIL EVERY 4TH POST EXCEPT ON GUARDRAIL RADIUS LESS THAN 50' SHALL BE EVERY POST. 9 EACH TOTAL THIS SITE

CONSTRUCTION NOTES: MP 5.18-5.24 LT

- ① 212.50 L.F. RAISING EXISTING BEAM GUARDRAIL
SEE RAISING BEAM GUARDRAIL DETAIL ON SHEET 4 OF 23

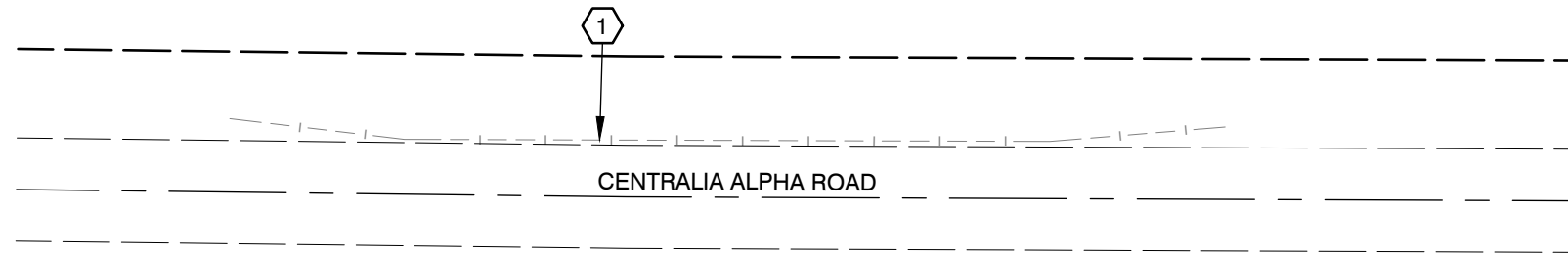

SITE 20
CENTRALIA ALPHA RD MP 5.18-5.24 LT

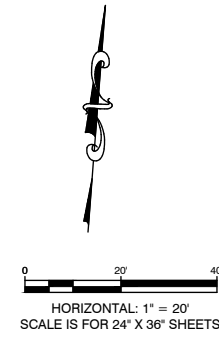

2025 NE KRESKY AVE.
CHEHALIS WA 98532
PHONE # (360) 740-1123
FAX # (360) 740-1479

DESIGNED BY :
DRAWN BY : KLP
CHECKED BY :
DATE :

NO.	DATE	REVISION	BY	APP.

2021 COUNTY SAFETY PROGRAM

FEDERAL-AID NO: HSP-000S(610)
COUNTY ROAD PROJECT NO: 2196
CENTRALIA ALPHA ROAD SITE 20

SHEET
16
OF
23



Wesley R Anderson, P.E.
Senior Engineer/Design
Date: 04/28/2023



TOWNSHIP 14/15 NORTH, RANGE 1 WEST W.M.

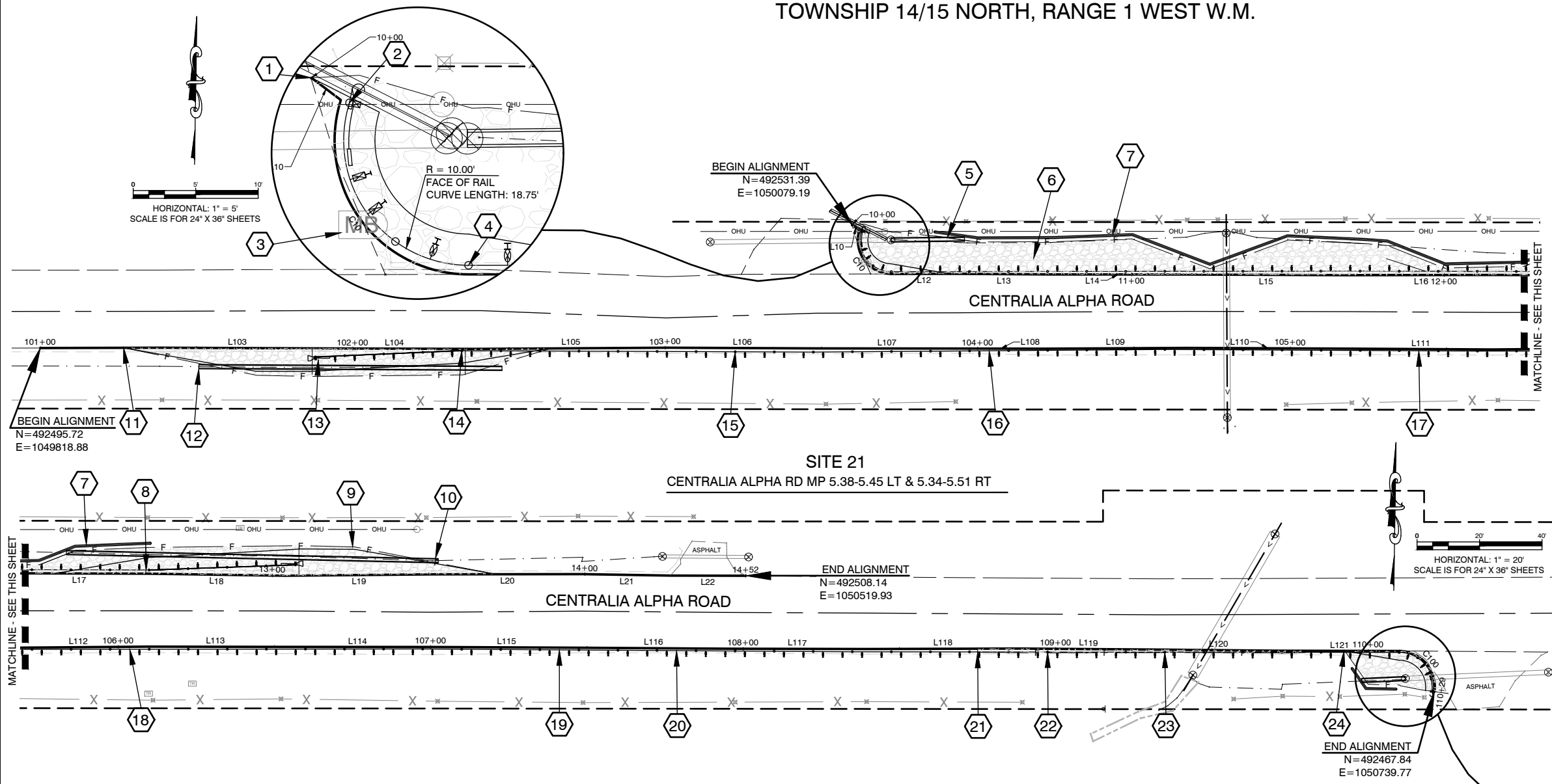

- GENERAL NOTES**
- CLEARING SHALL BE PAID LUMP SUM PER SPECIAL PROVISIONS. ALL EMBANKMENT AREAS SHALL BE CLEARED PRIOR TO EMBANKMENT CONSTRUCTION AND AFTER INSTALLATION OF EROSION CONTROL BMPs.
 - INSTALL GUARDRAIL REFLECTOR ON GUARDRAIL EVERY 4TH POST EXCEPT ON GUARDRAIL RADIUS LESS THAN 50' SHALL BE EVERY POST. 52 EACH TOTAL THIS SITE
 - WHERE GUARDRAIL POSTS MAY CONFLICT WITH UTILITIES, UTILIZE UNDERGROUND UTILITY VERIFICATION POTHOLE PER THE ENGINEER.

- CONSTRUCTION NOTES: MP 5.38-5.45 LT**
- STA 10+00.00 LT TO STA 10+40.19, LT
CONSTRUCT EMBANKMENT
20 TON CRUSHED SURFACING BASE COURSE
SEE GUARDRAIL TYPICAL SECTION B ON SHEET 4 OF 23
 - STA 10+01.93, 0.73' LT TO STA 10+21.60, 0.73' LT
1 EACH BEAM GUARDRAIL TYPE 31 ANCHOR 10
18.75 L.F. BEAM GUARDRAIL TYPE 31
SEE CASE 1 ON SHEET 5 OF 23
SEE STANDARD PLAN C-23.60
HAND DIG OR VAC DIG POST FOR ANCHOR
 - STA 10+13.30, 0.31' RT
MAILBOX TYPE 1
SEE STANDARD PLAN H-70.10
 - STA 10+21.60, 0.73' LT TO 12+59.09, 1.17' LT
237.50 L.F. BEAM GUARDRAIL TYPE 31 - 9 FT LONG POSTS
SEE CASE 5 ON SHEET 5 OF 23
 - STA 10+07.36, LT
18.00 L.F. SCHEDULE A CULV. PIPE 12 IN. DIAM
CULVERT EXTENSION SHALL USE LIKE MATERIAL AS EXISTING - CPP (CORRUGATED POLYETHYLENE PIPE)
2 C.Y. STRUCTURE EXCAVATION CLASS B INCL. HAUL
INLET INV. = EL 592.38 (STA 10+07.36, 10.68' LT) - TIE INTO EXISTING PIPE
OUTLET INV. = EL 591.78 (STA 10+40.42, 10.68' LT)
BEVEL PIPE TO MATCH SLOPE
SEE WSDOT STANDARD PLAN B-60.20
ADJUST EXISTING DRAINAGE PIPES AS NEEDED TO AVOID CONFLICT
PIPE ADJUSTMENT IS INCLUDED IN STRUCTURE EXCAVATION CLASS B INCL. HAUL
 - STA 10+40.19 LT TO 12+59.09 LT
CONSTRUCT EMBANKMENT
50 TON CRUSHED SURFACING BASE COURSE
SEE GUARDRAIL TYPICAL SECTION A ON SHEET 4 OF 23
 - STA 10+36.73 LT TO STA 12+61.16 LT
230.00 L.F. COIR LOG
SEE WSDOT STANDARD PLAN I-30.60
 - STA 12+59.09, 1.17' LT TO STA 13+05.98, 3.42' LT
1 EACH BEAM GUARDRAIL TYPE 31 NON-FLARED TERMINAL
SEE STANDARD PLAN C-22.40
 - STA 12+59.09 RT TO STA 13+71.59
CONSTRUCT EMBANKMENT
80 TON CRUSHED SURFACING BASE COURSE
SEE GUARDRAIL LANDING TYPICAL SECTION ON SHEET 4 OF 23
 - STA 12+34.11 LT TO STA 13+53.11 LT
119.00 L.F. SCHEDULE A CULV. PIPE 12 IN. DIAM
8 C.Y. STRUCTURE EXCAVATION CLASS B INCL. HAUL
INLET INV. = EL 591.88 (STA 13+53.11, 4.34' LT)
OUTLET INV. = EL 590.80 (STA 12+34.11, 6.68' LT)

Line Table: Alignments

Line #	Length	Direction
L10	2.95	S52°11'42"E
L12	21.01	S89°17'24"E
L13	30.10	S88°45'59"E
L14	42.91	S89°08'58"E
L15	51.95	S88°55'37"E
L16	47.36	S89°14'46"E
L17	43.80	S89°01'03"E
L18	44.06	S88°19'20"E
L19	47.08	S89°42'11"E
L20	47.96	S89°14'38"E
L21	28.09	S88°13'15"E
L22	24.15	S89°02'29"E

Line Table: Alignments

Line #	Length	Direction
L103	49.82	S88°54'52"E
L104	50.68	S88°58'20"E
L105	62.32	S89°31'58"E
L106	47.44	S88°53'54"E
L107	45.08	S89°06'51"E
L108	27.62	S89°03'37"E
L109	45.88	S89°28'00"E
L110	51.57	S88°54'40"E
L111	46.07	S88°50'54"E
L112	45.15	S89°38'32"E
L113	42.60	S89°02'57"E
L114	48.42	S89°07'40"E

Line Table: Alignments

Line #	Length	Direction
L115	46.90	S88°52'55"E
L116	47.21	S88°47'06"E
L117	44.83	S89°03'06"E
L118	48.39	S89°19'47"E
L119	44.68	S88°45'26"E
L120	38.61	S88°36'34"E
L121	38.43	S89°03'19"E

- CONSTRUCTION NOTES: MP 5.34-5.51 RT**
- STA 101+26.66 RT TO STA 102+63.34 RT
CONSTRUCT EMBANKMENT
60 TON CRUSHED SURFACING BASE COURSE
SEE GUARDRAIL LANDING TYPICAL SECTION ON SHEET 4 OF 23
 - STA 101+50.76 RT
97.00 L.F. SCHEDULE A CULV. PIPE 12 IN. DIAM
7 C.Y. STRUCTURE EXCAVATION CLASS B INCL. HAUL
INLET INV. = EL 601.11 (STA 101+50.76, 6.00' RT)
OUTLET INV. = EL 598.53 (STA 102+47.70, 6.26' RT)
 - STA 101+88.07, 2.72' RT TO STA 102+34.90, 0.57' RT
1 EACH BEAM GUARDRAIL TYPE 31 NON-FLARED TERMINAL
SEE STANDARD PLAN C-22.40
 - STA 102+34.90, 0.57' RT TO 103+22.40, 1.20' RT
87.50 L.F. BEAM GUARDRAIL TYPE 31 - 9 FT LONG POSTS
SEE CASE 4 ON SHEET 5 OF 23
 - STA 103+22.40, 1.20' RT TO 104+03.62, 0.71' RT
81.25 L.F. BEAM GUARDRAIL TYPE 31 - 9 FT LONG POSTS
SEE CASE 5 ON SHEET 5 OF 23
 - STA 104+03.62, 0.71' RT TO 105+41.15, 0.56' RT
137.50 L.F. BEAM GUARDRAIL TYPE 31 - 11 FT LONG POSTS
SEE CASE 6 ON SHEET 5 OF 23
 - STA 105+41.15, 0.56' RT TO 106+03.64, 0.80' RT
62.50 L.F. BEAM GUARDRAIL TYPE 31 - 9 FT LONG POSTS
SEE CASE 5 ON SHEET 5 OF 23
 - STA 106+03.64, 0.80' RT TO 107+41.15, 0.72' RT
137.50 L.F. BEAM GUARDRAIL TYPE 31 - 8 FT LONG POSTS
 - STA 107+41.15, 0.72' RT TO 107+78.65, 0.72' RT
37.50 L.F. BEAM GUARDRAIL TYPE 31 - 9 FT LONG POSTS
SEE CASE 5 ON SHEET 5 OF 23
 - STA 107+78.65, 0.72' RT TO 108+97.40, 1.03' RT
118.75 L.F. BEAM GUARDRAIL TYPE 31 - 8 FT LONG POSTS
SEE CASE 4 ON SHEET 5 OF 23
 - STA 108+75.00 RT TO STA 109+80.00 RT
CONSTRUCT EMBANKMENT
1 TON CRUSHED SURFACING BASE COURSE
SEE GUARDRAIL TYPICAL SECTION ON SHEET 4 OF 23
 - STA 108+97.40, 1.03' RT TO 109+34.90, 0.80' RT
37.50 L.F. BEAM GUARDRAIL TYPE 31 - 9 FT LONG POSTS
SEE CASE 5 ON SHEET 5 OF 23
 - STA 109+34.90, 0.80' RT TO 110+09.90, 0.45' RT
75 L.F. BEAM GUARDRAIL TYPE 31 - 11 FT LONG POSTS
SEE CASE 6 ON SHEET 5 OF 23
 - STA 109+92.26 RT TO STA 110+29.41 RT
CONSTRUCT EMBANKMENT
15 TON CRUSHED SURFACING BASE COURSE
SEE GUARDRAIL TYPICAL SECTION B ON SHEET 4 OF 23
 - STA 109+47.90, RT
14.00 L.F. SCHEDULE A CULV. PIPE 12 IN. DIAM
CULVERT EXTENSION SHALL USE LIKE MATERIAL AS EXISTING - CPP (CORRUGATED POLYETHYLENE PIPE)
1 C.Y. STRUCTURE EXCAVATION CLASS B INCL. HAUL
INLET INV. = EL 592.90 (STA 110+17.00, 8.13' RT) - TIE INTO EXISTING PIPE
OUTLET INV. = EL 591.90 (STA 109+47.90, 9.47' RT)
BEVEL PIPE TO MATCH SLOPE
SEE WSDOT STANDARD PLAN B-60.20
 - STA 109+94.66 RT TO STA 11+09.21 RT
18.00 L.F. COIR LOG
SEE WSDOT STANDARD PLAN I-30.60
 - STA 110+09.90, 0.45' RT TO STA 110+29.16, 0.45' RT
1 EACH BEAM GUARDRAIL TYPE 31 ANCHOR 10
18.75 L.F. BEAM GUARDRAIL TYPE 31
SEE CASE 1 ON SHEET 5 OF 23
SEE STANDARD PLAN C-23.60

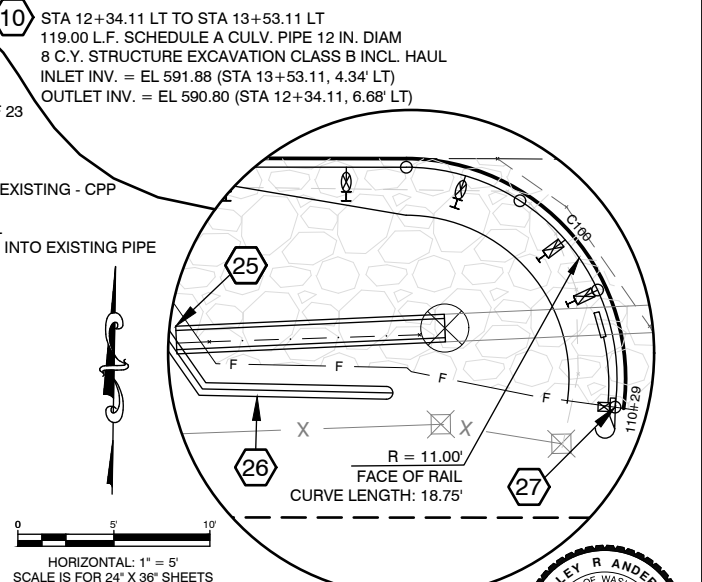

Lewis County
2025 NE KRESKY AVE.
CHEHALIS WA 98532
PHONE # (360) 740-1123
FAX # (360) 740-1479

DESIGNED BY :
DRAWN BY : KLP
CHECKED BY :
DATE :

NO.	DATE	REVISION	BY	APP.

2021 COUNTY SAFETY PROGRAM

FEDERAL-AID NO: HSP-000S(610)
COUNTY ROAD PROJECT NO: 2196
CENTRALIA ALPHA ROAD SITE 21

SHEET
17
OF
23



Wesley R Anderson, P.E.
Senior Engineer/Design
Date: 04/28/2023

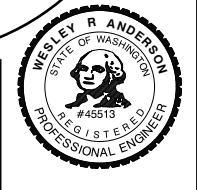

TOWNSHIP 14/15 NORTH, RANGE 1 WEST W.M.

- GENERAL NOTES**
- CLEARING SHALL BE PAID LUMP SUM PER SPECIAL PROVISIONS. ALL EMBANKMENT AREAS SHALL BE CLEARED PRIOR TO EMBANKMENT CONSTRUCTION AND AFTER INSTALLATION OF EROSION CONTROL BMPs.
 - INSTALL GUARDRAIL REFLECTOR ON GUARDRAIL EVERY 4TH POST EXCEPT ON GUARDRAIL RADIUS LESS THAN 50' SHALL BE EVERY POST. 35 EACH TOTAL THIS SITE
 - WHERE GUARDRAIL POSTS MAY CONFLICT WITH UTILITIES, UTILIZE UNDERGROUND UTILITY VERIFICATION POTHOLE PER THE ENGINEER.

Line Table: Alignments		
Line #	Length	Direction
L10	34.01	S88°31'20"E
L11	37.85	S88°50'04"E
L12	46.68	S88°50'46"E
L13	42.95	S89°07'05"E
L14	46.67	S89°08'00"E
L15	46.68	S88°42'49"E
L16	49.65	S88°40'01"E
L17	42.60	S89°02'28"E
L18	50.83	S89°09'29"E
L19	37.50	S89°03'09"E

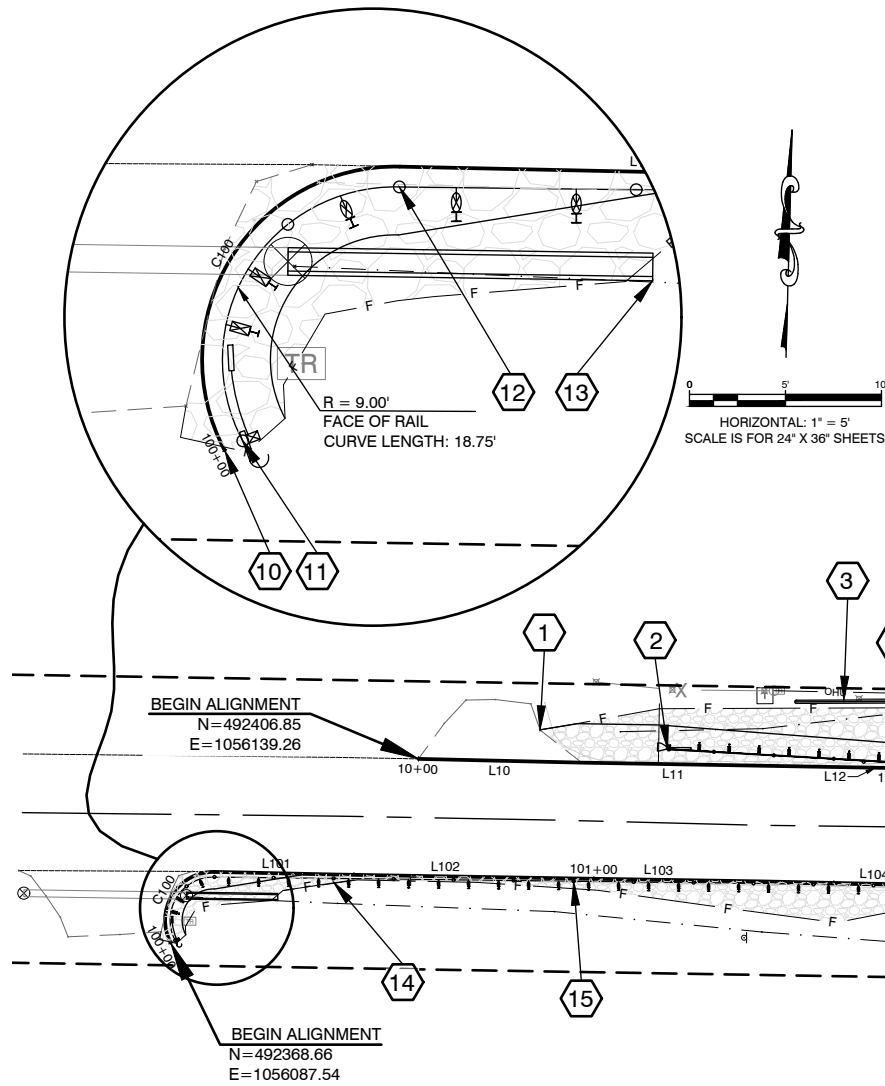

SITE 24
CENTRALIA ALPHA RD MP 6.54-6.61 LT & 6.52-6.61 RT

CONSTRUCTION NOTES: MP 6.52-6.61 RT

- STA 100+00.00 RT TO STA 100+35.28 RT
CONSTRUCT EMBANKMENT
5 TON CRUSHED SURFACING BASE COURSE
SEE GUARDRAIL TYPICAL SECTION B ON SHEET 4 OF 23
- STA 100+00.00, 1.07' RT TO STA 100+20.96, 1.06' RT
18.75 L.F. BEAM GUARDRAIL TYPE 31
SEE CASE 1 ON SHEET 5 OF 23
1 EACH BEAM GUARDRAIL TYPE 31 ANCHOR 10
SEE STANDARD PLAN C-23.60
- STA 100+20.96, 1.06' RT TO STA 100+95.79, 0.58' RT
75 L.F. BEAM GUARDRAIL TYPE 31 - 8 FT LONG POSTS
SEE CASE 4 ON SHEET 5 OF 23
- STA 100+34.24 RT
19.00 L.F. SCHEDULE A CULV. PIPE 12 IN. DIAM
CULVERT EXTENSION SHALL USE LIKE MATERIAL AS EXISTING - CMP (CORRUGATED METAL PIPE)
5 C.Y. STRUCTURE EXCAVATION CLASS B INCL. HAUL
INLET INV. = EL 660.30 (STA 100+34.24, 4.94' RT)
OUTLET INV. = EL 660.12 (STA 100+12.38, 2.48' RT) - TIE INTO EXISTING PIPE
DIG OUT DITCH TO EXPOSE EXISTING CULVERT
EXCAVATION FOR DIG OUT IS INCLUDED IN STRUCTURE EXCAVATION CLASS B INCL. HAUL
- STA 100+35.28 RT TO STA 102+75.00 RT
CONSTRUCT EMBANKMENT
10 TON CRUSHED SURFACING BASE COURSE
SEE GUARDRAIL TYPICAL SECTION A ON SHEET 4 OF 23
- STA 100+95.79, 0.58' RT TO STA 104+20.95, 0.40' RT
325 L.F. BEAM GUARDRAIL TYPE 31 - 9 FT LONG POSTS
SEE CASE 5 ON SHEET 5 OF 23
- STA 104+02.68 RT TO STA 104+33.87 RT
CONSTRUCT EMBANKMENT
5 TON CRUSHED SURFACING BASE COURSE
SEE GUARDRAIL TYPICAL SECTION B ON SHEET 4 OF 23
- STA 104+25.42 RT
10.00 L.F. SCHEDULE A CULV. PIPE 12 IN. DIAM
CULVERT EXTENSION SHALL USE LIKE MATERIAL AS EXISTING - CMP (CORRUGATED METAL PIPE)
1 C.Y. STRUCTURE EXCAVATION CLASS B INCL. HAUL
INLET INV. = EL 665.59 (STA 104+25.42, 9.24' RT) - TIE INTO EXISTING PIPE
OUTLET INV. = EL 665.30 (STA 104+12.24, 9.76' RT)
- STA 104+20.95, 0.40' RT TO STA 104+33.87, 0.40' RT
12.50 L.F. BEAM GUARDRAIL TYPE 31
SEE CASE 1 ON SHEET 5 OF 23
1 EACH BEAM GUARDRAIL TYPE 31 ANCHOR 10
SEE STANDARD PLAN C-23.60

Line Table: Alignments		
Line #	Length	Direction
L101	25.38	S88°36'45"E
L102	45.46	S88°52'51"E
L103	43.37	S88°55'52"E
L104	46.58	S88°37'42"E
L105	43.51	S89°03'35"E
L106	43.58	S89°13'37"E
L107	48.42	S88°35'30"E
L108	45.63	S88°49'15"E
L109	47.42	S88°54'40"E
L110	10.65	S87°59'39"E

Curve Table: Alignments			
Curve #	Radius	Length	Chord Direction
C100	10.06	20.96	N31°50'03"E
C101	12.40	12.92	S59°09'19"E

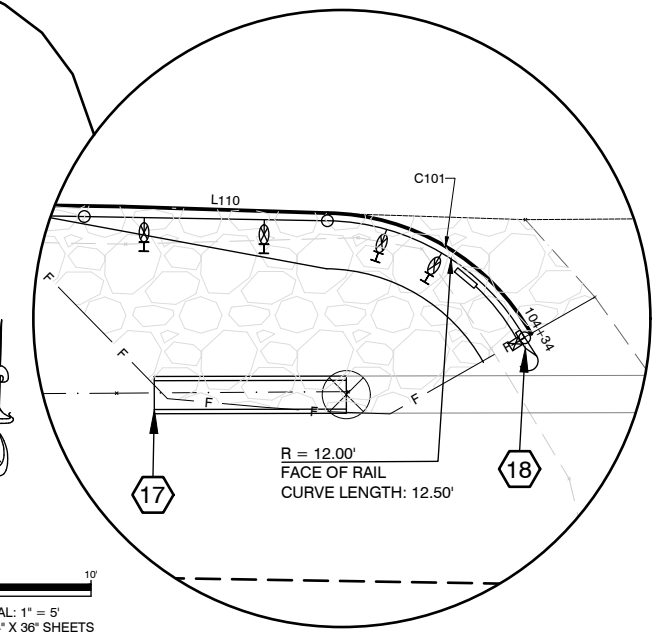

Lewis County
Department of Public Works
2025 NE KRESKY AVE.
CHEHALIS WA 98532
PHONE # (360) 740-1123
FAX # (360) 740-1479

DESIGNED BY :
DRAWN BY : KLP
CHECKED BY :
DATE :

NO.	DATE	REVISION	BY	APP.

2021 COUNTY SAFETY PROGRAM

FEDERAL-AID NO: HSP-000S(610)
COUNTY ROAD PROJECT NO: 2196
CENTRALIA ALPHA ROAD SITE 24

SHEET
18
OF
23



Wesley R Anderson, P.E.
Senior Engineer/Design
Date: 04/28/2023



TOWNSHIP 14/15 NORTH, RANGE 1 WEST W.M.

- GENERAL NOTES**
- ① WHERE GUARDRAIL POSTS MAY CONFLICT WITH UTILITIES, UTILIZE UNDERGROUND UTILITY VERIFICATION POTHOLE PER THE ENGINEER.
 - ② INSTALL GUARDRAIL REFLECTOR ON GUARDRAIL EVERY 4TH POST EXCEPT ON GUARDRAIL RADIUS LESS THAN 50' SHALL BE EVERY POST. 36 EACH TOTAL THIS SITE

CONSTRUCTION NOTES: MP 7.01-7.11 LT

- ① 412.50 L.F. RAISING EXISTING BEAM GUARDRAIL
SEE RAISING BEAM GUARDRAIL DETAIL ON SHEET 4 OF 23

CONSTRUCTION NOTES: 7.00-7.11 RT

- ② 462.50 L.F. RAISING EXISTING BEAM GUARDRAIL
SEE RAISING BEAM GUARDRAIL DETAIL ON SHEET 4 OF 23

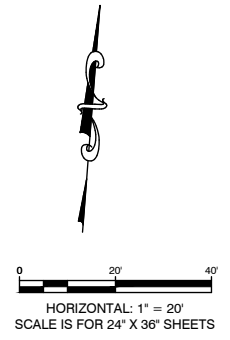
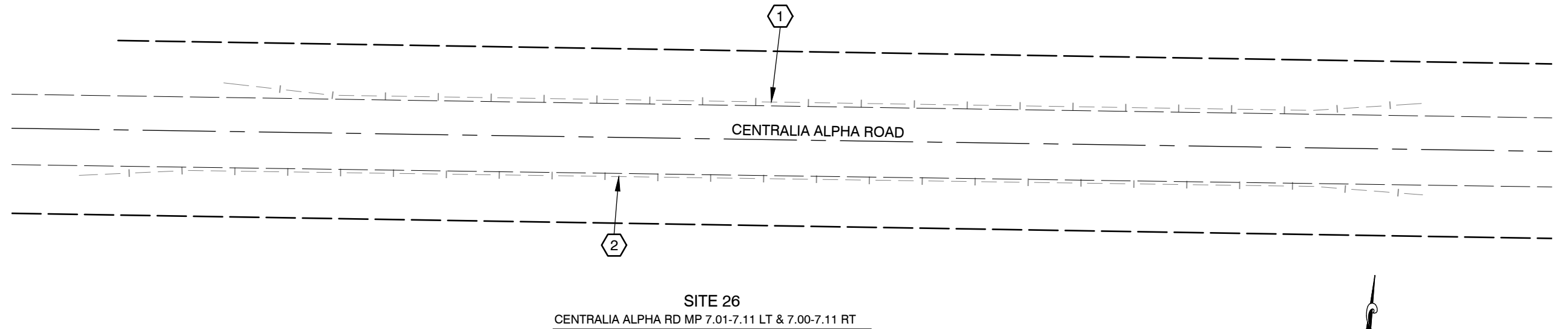

Lewis County
 Department of Public Works
 2025 NE KRESKY AVE.
 CHEHALIS WA 98532
 PHONE # (360) 740-1123
 FAX # (360) 740-1479

DESIGNED BY :
 DRAWN BY : KLP
 CHECKED BY :
 DATE :

NO.	DATE	REVISION	BY	APP.

2021 COUNTY SAFETY PROGRAM

FEDERAL-AID NO: HSP-000S(610)
 COUNTY ROAD PROJECT NO: 2196
 CENTRALIA ALPHA ROAD SITE 26

SHEET
19
 OF
23



Wesley R Anderson, P.E.
 Senior Engineer/Design
 Date: 04/28/2023



TOWNSHIP 13 NORTH, RANGE 1 WEST W.M.

- GENERAL NOTES**
- ① WHERE GUARDRAIL POSTS MAY CONFLICT WITH UTILITIES, UTILIZE UNDERGROUND UTILITY VERIFICATION POTHOLE PER THE ENGINEER.
 - ② INSTALL GUARDRAIL REFLECTOR ON GUARDRAIL EVERY 4TH POST EXCEPT ON GUARDRAIL RADIUS LESS THAN 50' SHALL BE EVERY POST. 40 EACH TOTAL THIS SITE

CONSTRUCTION NOTES: MP 9.10-9.32 RT

- ① 1,000.00 L.F. RAISING EXISTING BEAM GUARDRAIL
SEE RAISING BEAM GUARDRAIL DETAIL ON SHEET 4 OF 23



CENTRALIA ALPHA ROAD

①

MATCHLINE - SEE THIS SHEET

SITE 30
CENTRALIA ALPHA RD MP 9.10-9.32 RT

CENTRALIA ALPHA ROAD

MATCHLINE - SEE THIS SHEET



Lewis County
Department of Public Works

2025 NE KRESKY AVE.
CHEHALIS WA 98532
PHONE # (360) 740-1123
FAX # (360) 740-1479

DESIGNED BY :
DRAWN BY : KLP
CHECKED BY :
DATE :

NO.	DATE	REVISION	BY	APP.

2021 COUNTY SAFETY PROGRAM

FEDERAL-AID NO: HSP-000S(610)
COUNTY ROAD PROJECT NO: 2196
CENTRALIA ALPHA ROAD SITE 30

SHEET
20
OF
23



Wesley R Anderson, P.E.
Senior Engineer/Design
Date: 04/28/2023

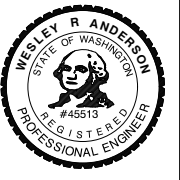

TOWNSHIP 13 NORTH, RANGE 1 EAST W.M.

Line Table: Alignments		
Line #	Length	Direction
L15	46.19	N74°10'28"E
L16	42.37	N74°23'05"E
L17	48.23	N74°33'52"E
L18	49.99	N74°33'46"E
L19	48.34	N74°21'22"E
L20	49.06	N74°18'21"E
L21	53.98	N74°23'28"E
L22	48.45	N74°25'08"E
L23	50.33	N74°28'36"E

CONSTRUCTION NOTES: MP 12.88-12.97 LT

- ① STA 12+07.22 LT TO STA 13+49.04 LT
CONSTRUCT EMBANKMENT
130 TON CRUSHED SURFACING BASE COURSE
SEE GUARDRAIL LANDING TYPICAL SECTION ON SHEET 4 OF 23
- ② STA 12+10.74 LT TO STA 13+46.20 LT
STA 15+07.02 LT TO STA 15+81.22 LT
215 L.F. COIR LOG
SEE WSDOT STANDARD PLAN I-30.60
- ③ STA 12+72.95, 2.76' LT TO STA 13+19.77, 0.75' LT
1 EACH BEAM GUARDRAIL TYPE 31 NON-FLARED TERMINAL
SEE STANDARD PLAN C-22.40
- ④ STA 13+19.77, 0.75' LT TO STA 13+82.27, 0.95' LT
62.50 L.F. BEAM GUARDRAIL TYPE 31 - 9 FT LONG POSTS
SEE CASE 5 ON SHEET 5 OF 23
- ⑤ STA 13+82.27, 0.95' LT TO STA 14+07.27, 1.04' LT
25 L.F. BEAM GUARDRAIL TYPE 31 - 8 FT LONG POSTS
SEE CASE 4 ON SHEET 5 OF 23
- ⑥ STA 14+07.27, 1.04' LT TO STA 14+26.02, 1.09' LT
18.75 L.F. BEAM GUARDRAIL TYPE 31 - 11 FT LONG POSTS
SEE CASE 6 ON SHEET 5 OF 23
- ⑦ STA 14+10.39 LT
OMIT ONE POST
- ⑧ STA 14+26.02, 1.09' LT TO STA 14+44.77, 1.09' LT
87.50 L.F. BEAM GUARDRAIL TYPE 31 - 9 FT LONG POSTS
SEE CASE 5 ON SHEET 5 OF 23
- ⑨ STA 14+44.77, 1.09' LT TO STA 15+32.27, 1.01' LT
18.75 L.F. BEAM GUARDRAIL TYPE 31 - 8 FT LONG POSTS
SEE CASE 4 ON SHEET 5 OF 23
- ⑩ STA 15+01.04 LT TO STA 16+44.19 LT
CONSTRUCT EMBANKMENT
25 TON CRUSHED SURFACING BASE COURSE
SEE GUARDRAIL LANDING TYPICAL SECTION ON SHEET 4 OF 23
- ⑪ STA 15+32.27, 1.01' LT TO STA 15+79.11, 2.91' LT
1 EACH BEAM GUARDRAIL TYPE 31 NON-FLARED TERMINAL
SEE STANDARD PLAN C-22.40

- GENERAL NOTES**
- ① CLEARING SHALL BE PAID LUMP SUM PER SPECIAL PROVISIONS. ALL EMBANKMENT AREAS SHALL BE CLEARED PRIOR TO EMBANKMENT CONSTRUCTION AND AFTER INSTALLATION OF EROSION CONTROL BMPs.
 - ② INSTALL GUARDRAIL REFLECTOR ON GUARDRAIL EVERY 4TH POST EXCEPT ON GUARDRAIL RADIUS LESS THAN 50' SHALL BE EVERY POST. 24 EACH TOTAL THIS SITE
 - ③ WHERE GUARDRAIL POSTS MAY CONFLICT WITH UTILITIES, UTILIZE UNDERGROUND UTILITY VERIFICATION POTHOLE PER THE ENGINEER.

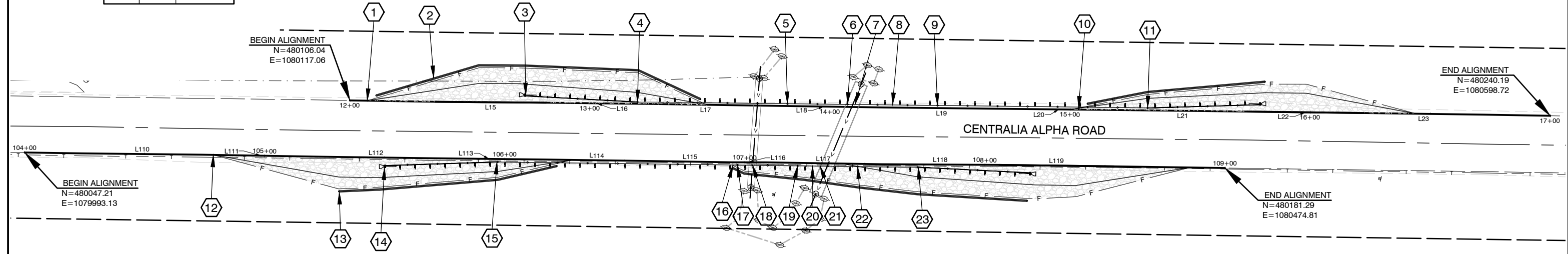

SITE 33
CENTRALIA ALPHA RD MP 12.88-12.97 LT & 12.87-12.96 RT

CONSTRUCTION NOTES: MP 12.87-12.96 RT

- ⑫ STA 104+78.58 RT TO STA 106+28.18 RT
CONSTRUCT EMBANKMENT
40 TON CRUSHED SURFACING BASE COURSE
SEE GUARDRAIL LANDING TYPICAL SECTION ON SHEET 4 OF 23
- ⑬ STA 105+30.90 RT TO STA 106+21.90 RT
STA 106+94.90 RT TO STA 108+17.97 RT
216 L.F. COIR LOG
SEE WSDOT STANDARD PLAN I-30.60
- ⑭ STA 105+50.16, 3.32' RT TO STA 105+96.99, 1.26' RT
1 EACH BEAM GUARDRAIL TYPE 31 NON-FLARED TERMINAL
SEE STANDARD PLAN C-22.40
- ⑮ STA 105+96.99, 1.26' RT TO STA 106+96.98, 1.16' RT
100 L.F. BEAM GUARDRAIL TYPE 31 - 8 FT LONG POSTS
SEE CASE 4 ON SHEET 5 OF 23
- ⑯ STA 106+95.00 RT TO STA 107+47.52 RT
CONSTRUCT EMBANKMENT
- ⑰ 5 TON CRUSHED SURFACING BASE COURSE
SEE GUARDRAIL TYPICAL SECTION A ON SHEET 4 OF 23
STA 106+96.98, 1.16' RT TO STA 107+03.23, 1.23' RT
6.25 L.F. BEAM GUARDRAIL TYPE 31 - 11 FT LONG POSTS
SEE CASE 6 ON SHEET 5 OF 23
- ⑱ STA 107+03.23, 1.23' RT TO STA 107+21.99, 1.24' RT
18.75 L.F. BEAM GUARDRAIL TYPE 31 - 9 FT LONG POSTS
SEE CASE 5 ON SHEET 5 OF 23
- ⑲ STA 107+21.99, 1.24' RT TO STA 107+28.24, 1.22' RT
6.25 L.F. BEAM GUARDRAIL TYPE 31 - 11 FT LONG POSTS
SEE CASE 6 ON SHEET 5 OF 23
- ⑳ STA 107+28.24, 1.22' RT TO STA 107+71.98, 1.16' RT
- ㉑ 43.75 L.F. BEAM GUARDRAIL TYPE 31 - 9 FT LONG POSTS
SEE CASE 5 ON SHEET 5 OF 23
STA 107+31.37 RT
OMIT ONE POST
- ㉒ STA 107+47.52 RT TO STA 108+85.39 RT
CONSTRUCT EMBANKMENT
70 TON CRUSHED SURFACING BASE COURSE
SEE GUARDRAIL LANDING TYPICAL SECTION ON SHEET 4 OF 23
- ㉓ STA 107+71.98, 1.16' RT TO STA 108+18.83, 3.13' RT
1 EACH BEAM GUARDRAIL TYPE 31 NON-FLARED TERMINAL
SEE STANDARD PLAN C-22.40

Line Table: Alignments		
Line #	Length	Direction
L110	49.98	N74°20'11"E
L111	48.81	N74°41'27"E
L112	47.04	N74°28'54"E
L113	46.88	N74°21'44"E
L114	43.26	N74°29'33"E
L115	34.37	N74°37'02"E
L116	14.10	N73°46'54"E
L117	48.48	N74°38'08"E
L118	48.98	N74°02'03"E
L119	47.78	N74°26'06"E

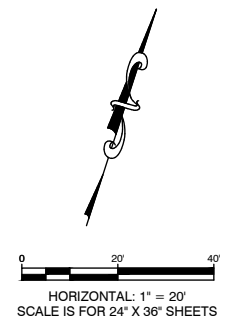

Lewis County
Department of Public Works
2025 NE KRESKY AVE.
CHEHALIS WA 98532
PHONE # (360) 740-1123
FAX # (360) 740-1479

NO.	DATE	REVISION	BY	APP.

2021 COUNTY SAFETY PROGRAM

FEDERAL-AID NO: HSP-000S(610)
COUNTY ROAD PROJECT NO: 2196
CENTRALIA ALPHA ROAD SITE 33

SHEET
21
OF
23

CALL 48 HOURS BEFORE YOU DIG
1-800-424-5555
"It's the Law"
Utilities Underground Location Center

Wesley R Anderson, P.E.
Senior Engineer/Design
Date: 04/28/2023

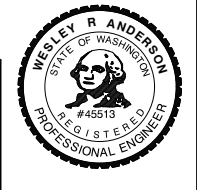

TOWNSHIP 13 NORTH, RANGE 1 EAST W.M.

Line Table: Alignments		
Line #	Length	Direction
L10	18.81	S68°07'58"E
L11	56.86	S65°54'56"E
L12	47.58	S64°02'21"E
L13	49.24	S62°46'10"E
L14	45.45	S62°35'15"E
L15	47.17	S61°09'34"E
L16	51.16	S59°45'59"E
L17	43.75	S58°10'49"E
L18	46.65	S55°58'19"E
L19	47.43	S54°48'16"E
L20	45.12	S53°20'37"E

Curve Table: Alignments			
Curve #	Radius	Length	Chord Direction
C10	9.05	14.15	S23°20'15"E

CONSTRUCTION NOTES: MP 13.24-13.34 LT

- ① STA 10+00.00 LT TO STA 10+29.48 LT
CONSTRUCT EMBANKMENT
10 TON CRUSHED SURFACING BASE COURSE
SEE GUARDRAIL TYPICAL SECTION B ON SHEET 4 OF 23
- ② STA 10+00.00, 1.05' LT TO STA 10+14.14, 1.05' LT
12.50 L.F. BEAM GUARDRAIL TYPE 31
SEE CASE 1 ON SHEET 5 OF 23
1 EACH BEAM GUARDRAIL TYPE 31 ANCHOR 10
SEE STANDARD PLAN C-23.60
- ③ STA 10+14.14, 1.05' LT TO STA 10+39.11, 1.02' LT
25 L.F. BEAM GUARDRAIL TYPE 31 - 8 FT LONG POSTS
SEE CASE 4 ON SHEET 5 OF 23
- ④ STA 10+29.48 LT TO STA 11+75.00 LT
CONSTRUCT EMBANKMENT
2 TON CRUSHED SURFACING BASE COURSE
SEE GUARDRAIL TYPICAL SECTION A ON SHEET 4 OF 23

- ⑤ STA 10+39.11, 1.02' LT TO STA 12+76.53, 0.69' LT
237.50 L.F. BEAM GUARDRAIL TYPE 31 - 9 FT LONG POSTS
SEE CASE 5 ON SHEET 5 OF 23
- ⑥ STA 12+44.34 LT TO STA 14+10.32 LT
CONSTRUCT EMBANKMENT
50 TON CRUSHED SURFACING BASE COURSE
SEE GUARDRAIL LANDING TYPICAL SECTION ON SHEET 4 OF 23
- ⑦ STA 12+76.53, 0.69' LT TO STA 13+23.34, 2.81' LT
1 EACH BEAM GUARDRAIL TYPE 31 NON-FLARED TERMINAL
SEE STANDARD PLAN C-22.40
- ⑧ STA 12+50.42 LT TO STA 14+03.67 LT
158 L.F. COIR LOG
SEE WSDOT STANDARD PLAN I-30.60

- ① GENERAL NOTES
CLEARING SHALL BE PAID LUMP SUM PER SPECIAL PROVISIONS. ALL EMBANKMENT AREAS SHALL BE CLEARED PRIOR TO EMBANKMENT CONSTRUCTION AND AFTER INSTALLATION OF EROSION CONTROL BMPs.
- ② INSTALL GUARDRAIL REFLECTOR ON GUARDRAIL EVERY 4TH POST EXCEPT ON GUARDRAIL RADIUS LESS THAN 50' SHALL BE EVERY POST. 15 EACH TOTAL THIS SITE
- ③ SEE SHEET 4 OF 23 FOR TYPICAL SECTION VIEWS.
- ④ WHERE GUARDRAIL POSTS MAY CONFLICT WITH UTILITIES, UTILIZE UNDERGROUND UTILITY VERIFICATION POTHOLE PER THE ENGINEER.

CONSTRUCTION NOTES: MP 13.26-13.31 RT

- ⑨ STA 101+74.00 RT
STA 102+48.86 RT TO STA 104+01.00 RT
163 L.F. COIR LOG
SEE WSDOT STANDARD PLAN I-30.30
- ⑩ STA 101+75.00 RT TO STA 104+00.00 RT
CONSTRUCT EMBANKMENT
170 TON CRUSHED SURFACING BASE COURSE
9 C.Y. ROADWAY EXCAVATION INCL. HAUL
44 S.Y. SEEDING AND FERTILIZING BY HAND
- ⑪ STA 102+18.79 RT
11.50 L.F. CL. IV REINF. CONC. CULV. PIPE 12 IN. DIAM
1 C.Y. STRUCTURE EXCAVATION CLASS B INCL. HAUL
INLET INV. = EL 685.26 (STA 102+18.79, 8.71' RT) - TIE INTO EXISTING PIPE
OUTLET INV. = EL 682.91 (STA 102+22.23, 19.69' RT)

Line Table: Alignments		
Line #	Length	Direction
L100	48.76	S69°53'30"E
L101	48.27	S68°10'09"E
L102	56.01	S65°43'01"E
L103	46.95	S64°14'14"E
L104	47.44	S62°53'47"E
L105	46.91	S62°15'10"E
L106	46.14	S61°06'06"E
L107	50.00	S59°48'02"E
L108	44.04	S58°27'53"E
L109	44.76	S55°40'54"E
L110	47.18	S54°55'51"E
L111	45.07	S53°12'31"E

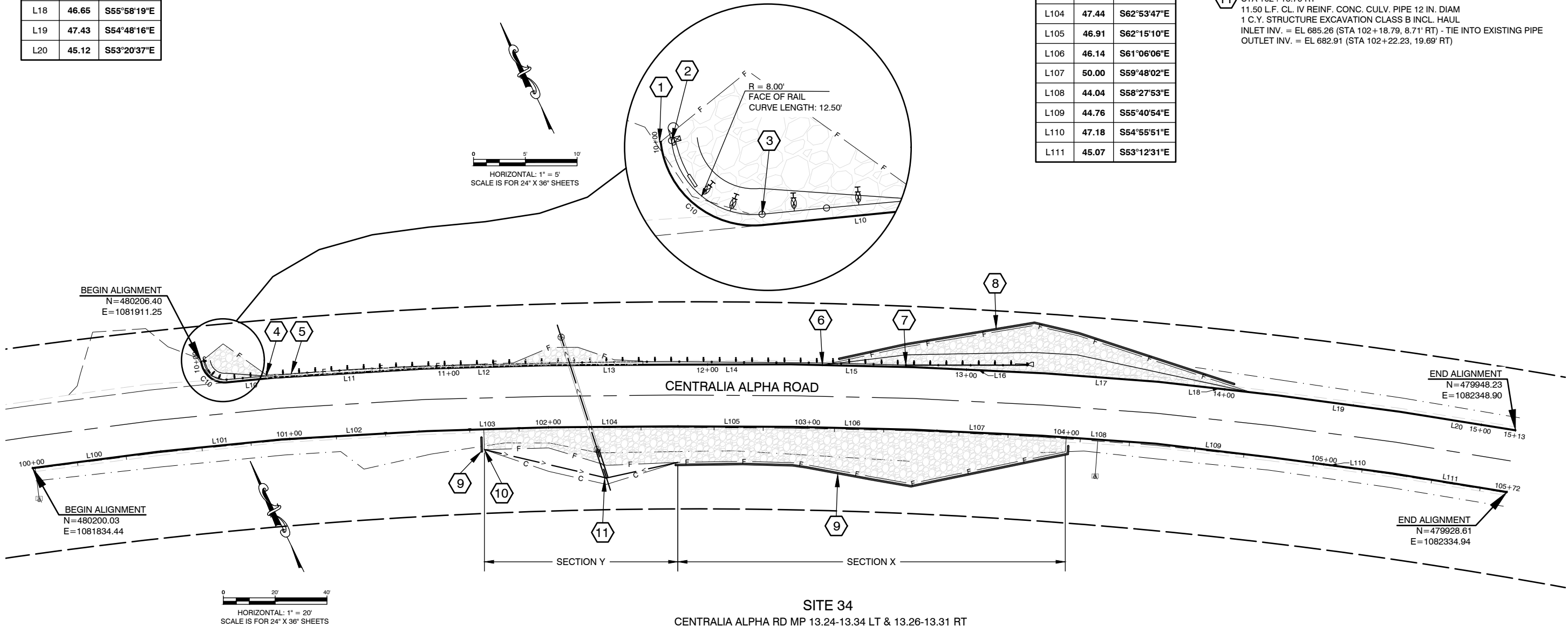

SITE 34
CENTRALIA ALPHA RD MP 13.24-13.34 LT & 13.26-13.31 RT

Lewis County
Department of Public Works
2025 NE KRESKY AVE.
CHEHALIS WA 98532
PHONE # (360) 740-1123
FAX # (360) 740-1479

DESIGNED BY :
DRAWN BY : KLP
CHECKED BY :
DATE :

NO.	DATE	REVISION	BY	APP.

2021 COUNTY SAFETY PROGRAM

FEDERAL-AID NO: HSIP-000S(610)
COUNTY ROAD PROJECT NO: 2196

CENTRALIA ALPHA ROAD SITE 34

SHEET
22
OF
23



Wesley R Anderson, P.E.
Senior Engineer/Design

Date: 04/28/2023





BUFFER DATA										
LONGITUDINAL BUFFER SPACE = B										
SPEED (MPH)	25	30	35	40	45	50	55	60	65	70
LENGTH (FEET)	155	200	250	305	360	425	495	570	645	-
BUFFER VEHICLE ROLL AHEAD DISTANCE = R										
TRANSPORTABLE ATTENUATOR MINIMUM HOST VEHICLE WEIGHT 15,000 LBS. THE MAXIMUM WEIGHT SHALL BE IN ACCORDANCE WITH THE MANUFACTURERS RECOMMENDATION.								30 FEET MIN. TO 100 FEET MAX.		
PROTECTIVE VEHICLE MAY BE A WORK VEHICLE STRATEGICALLY LOCATED TO SHIELD THE WORK AREA.								NO SPECIFIED DISTANCE REQUIRED		

SIGN SPACING = X (1)		
RURAL HIGHWAYS	60 / 65 MPH	600' ±
RURAL ROADS	45 / 55 MPH	500' ±
RURAL ROADS & URBAN ARTERIALS	35 / 40 MPH	350' ±
RURAL ROADS, URBAN ARTERIALS, RESIDENTIAL & BUSINESS DISTRICTS	25 / 30 MPH	200' ± (2)
URBAN STREETS	25 MPH OR LESS	100' ± (2)

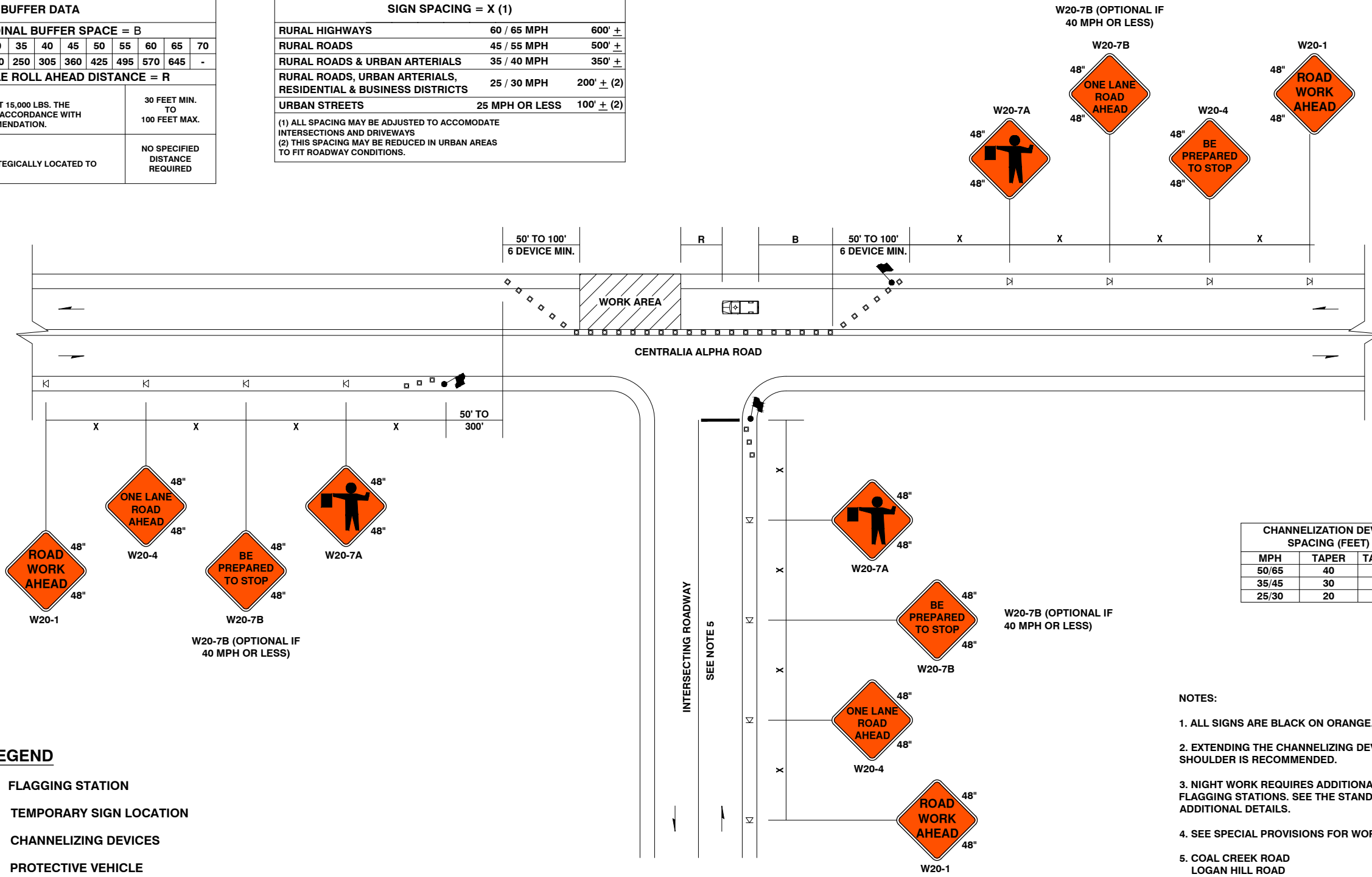
(1) ALL SPACING MAY BE ADJUSTED TO ACCOMMODATE INTERSECTIONS AND DRIVEWAYS
(2) THIS SPACING MAY BE REDUCED IN URBAN AREAS TO FIT ROADWAY CONDITIONS.



ONE-LANE, TWO WAY TRAFFIC CONTROL WITH FLAGGERS
NOT TO SCALE

 <p>2025 N. E. KRESKY AVE. CHEHALIS WA 98532 PHONE # (360) 740-1123 FAX # (360) 740-2719</p>	<p>DESIGNED BY : RAW DRAWN BY : RAW CHECKED BY : WRA DATE : 10/25/2022</p>	<table border="1"> <thead> <tr> <th>NO.</th> <th>DATE</th> <th>REVISION</th> <th>BY</th> <th>APP.</th> </tr> </thead> <tbody> <tr><td> </td><td> </td><td> </td><td> </td><td> </td></tr> <tr><td> </td><td> </td><td> </td><td> </td><td> </td></tr> <tr><td> </td><td> </td><td> </td><td> </td><td> </td></tr> <tr><td> </td><td> </td><td> </td><td> </td><td> </td></tr> </tbody> </table>			NO.	DATE	REVISION	BY	APP.																					<p>2021 COUNTYWIDE SAFETY PROGRAM</p>	<p>FEDERAL-AID NO: HSIP-000S(610) COUNTY ROAD PROJECT NO: 2196</p>	<p>SHEET 23 OF 23</p>	 <p>CALL 48 HOURS BEFORE YOU DIG 1-800-424-5555 "It's the Law" Utilities Underground Location Center</p>
		NO.	DATE	REVISION	BY	APP.																											
<p>Department of Public Works</p>		<p>TRAFFIC CONTROL PLAN (TC-1)</p>																															